



# Lockout Tagout

// PRODUCT CATALOGUE



# What can Brady offer you?

Helping workplaces increase safety, security, productivity and performance. Brady's range of products include high performance labels and signs designed for the harshest environments, printing systems and software, lockout safety devices and tags, first aid products and equipment, spill control and more.

## WHEN YOU CHOOSE BRADY, YOU GET THE TOTAL SOLUTION



### **ALL THE SAFETY AND IDENTIFICATION PRODUCTS YOU NEED**

Consolidating suppliers can save you time. With so many brands under the one roof, we have over 50,000 products available. We want to make sure every single customer walks away from Brady with exactly what they are looking for.



### **IN-HOUSE MANUFACTURING AND FAST DELIVERY**

We know speed of delivery is important. Our in-house production department runs at full speed every day, manufacturing a range of products from safety signs and labels, to engraved tags and wire identification products.

We have a dedicated team of 30 operators working 10 machines daily, so we can provide our customers with a quick turn around on orders.



### **OUR COMPLIANCE EXPERTISE**

Our speciality is our ability to ensure our customers' peace of mind, knowing that their compliance obligations are fulfilled. We achieve this by delivering the latest information on relevant workplace safety, supported by our national sales team who are your trusted business advisors for workplace safety and compliance.



### **A CULTURE OF MAKING IT EASY FOR THE CUSTOMER**

Our employees share common values like integrity and respect. We put our customer at the centre of everything we do, working with them to find solutions for their needs. We do this with friendly service because that's who we are.



### **WE OFFER ONLY BEST-IN-CLASS PRODUCTS**

We ensure we partner with suppliers who share our sense of integrity and ethical practices. We partner with best-in-class local and overseas vendors, making sure we bring to market quality products that our customers can rely on.



### **UNIQUE PRODUCT OFFERING**

Brady global Research and Development has over 250 technologists in Research and Development laboratory sites. This allows us to focus on areas of strength and differentiation, expand our portfolio of products and continually invest in new technology platforms for the future.

# Contents



Lockout Tagout  
Compliance

6-11



Brady Safety Padlocks

14-19



Circuit Breaker  
Lockout Devices

20-25



Valve and Cable Lockouts

26-32



Electrical Equipment  
Lockout

33-34



Lockout Hasps and  
Group Lock Boxes

35-40



Portable Lockout Kits

41-43



Lockout Boards

44-45



Lockout Stations

46-48



Lockout Tags

49-53



Scaffold Holder &  
Insert Systems

54-58



Lockout Signs  
& Labels

59-61



# Lockout Tagout in Your Workplace



Lockout Signs



Cable Lockout



Gate Valve Lockout



Tags



Lockout Signs



Circuit Breaker Lockout

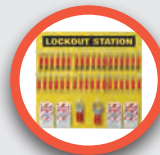

Lockout Boards



Electrical Equipment Lockout



Plug Lockout



Padlocks



**WANT TO KNOW MORE? GO TO:**  
[www.bradyid.com.au/videos](http://www.bradyid.com.au/videos)



Lockout tags and padlocks should be used in conjunction with breakers, devices and gate valves.

A close-up photograph of a person's hand holding a dark-colored pen with gold-colored accents, writing on a white sheet of paper. The background is blurred, showing a person in a light blue shirt. The entire image is framed by a thick orange border.

Lockout Tagout

# Compliance





Lockout Tagout is a critical component of employee safety and workplace productivity. In fact, it is essential to safeguarding workers and employees around the machinery and equipment they operate, service and maintain.

Australian workers continue to be injured or killed due to the unintentional release of hazardous energy sources. These incidents could have been prevented with a clearly documented Lockout Procedure. That way, your employees can get their job done as safely as possible to keep your operation running efficiently.



# Lockout Tagout at a glance



## LOCKOUT

Physically ensuring an equipment is inoperable while repairs or adjustments are made with the use of a padlock and a suitable device.

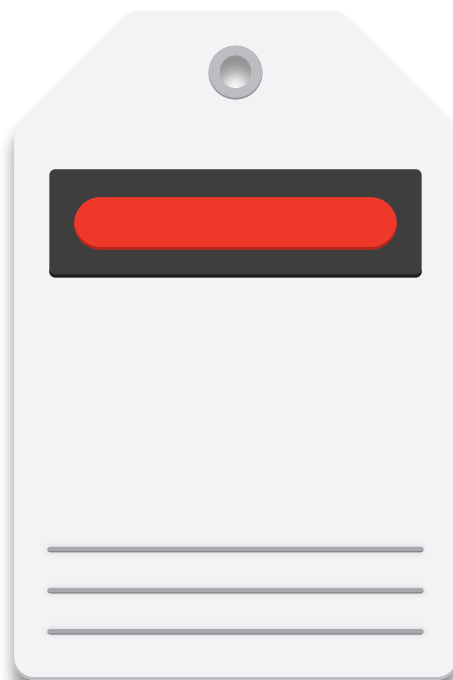

## TAGOUT

Clearly communicating to workers, with labels and tags, that the equipment is being serviced, should not be operated and when it will return to service.

Lockout Tagout is used for energy isolation, which means zero energy. Testing of the isolation point of all forms of energy to ensure complete isolation, i.e. zero energy, needs to be verified before operating on the machine or device. When it comes to your lockout program, your employees are the priority.

An effective energy isolation program can protect workers and protect assets. Brady offers a comprehensive Lockout solution to ensure your energy isolation procedures are partnered with effective Lockout Tagout products.

## COMPLETE LOCKOUT



### STEP 1

Choose Device and attach to energy source



### STEP 2

Choose Padlock and attach to device to secure Lockout



### STEP 3

Choose Tag and attach to padlock for communication



# 5 Steps to an Effective Lockout Program

1



Develop and document your energy control policy/program

2



Create and post written, equipment-specific lockout procedures

3



Identify and mark all energy control points

4



Train your employee, communicate and conduct periodic inspections

5



Equip your employees with the proper lockout tools and warning devices

## Lockout Safety Regulatory Guidance

Hazardous Energy regulations and standards outline the requirements for isolation procedures and risk controls. The high-risk nature of work in this area means that they are likely to have a higher incidence of work-related injury and disease. Therefore, appropriate regulations and standards should be followed to prevent injuries in your workplace.

### THE FOLLOWING STANDARDS CAN BE REFERRED TO FOR SAFE GUIDELINES:

**AS/NZS 4836:2011** – Safe working on or near low-voltage electrical installations and equipment. This Standard provides a framework around isolation of potential energy sources and elimination of potential hazards.

**AS 4024.1603-2006** – Safety of machinery – Design of controls, interlocks and guards – Prevention of unexpected start-up. This Standard details the requirements for “Prevention of unexpected start-up” of equipment.

**AUSTRALIAN WORK HEALTH AND SAFETY REGULATIONS 2011** – The WHS regulations (Part 4.7) outline specific requirements pertaining to Electrical Safety and Energised Electrical Work. Managing Risks of Plant in Workplace – Code of Practice 2016, Safe Work Australia.

**NOTE:** The above content is provided as a guide only and businesses should check with their local State or Territory regulatory authority for full details on energy isolation standards relevant to them.



Consistently review your lockout program for continuous improvement.





# Brady – Your Lockout Tagout Specialist

The global leader in providing Lockout Tagout solutions; Brady offers a comprehensive range of quality, easy to use lockout devices. Brady covers other critical aspects of a compliant, effective energy control program by providing innovative solutions. Brady's Complete Hazard Solution assists Australian industries in protecting their workers from potential hazards. Below are some of those potential hazards which could be faced on a daily basis.

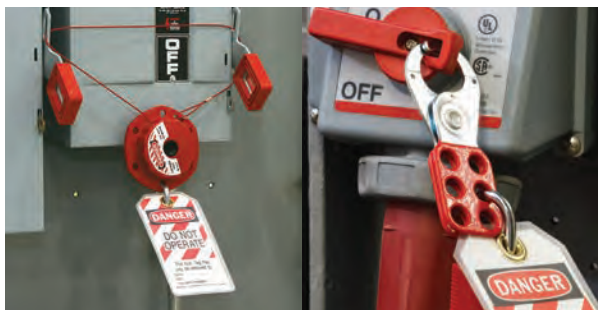

## CONSTRUCTION

Various lockout devices such as padlocks, hasps, tags and more for a range of solutions.

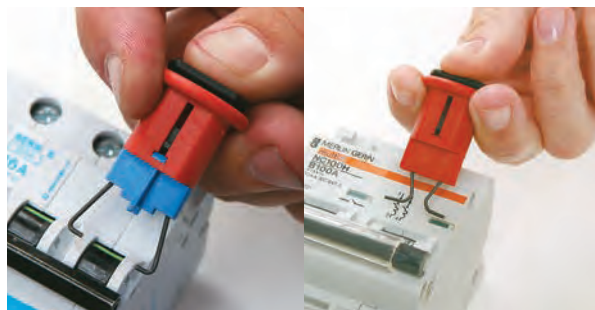

## ELECTRICAL LOCKOUT

Lockout equipment to prevent re-energising.

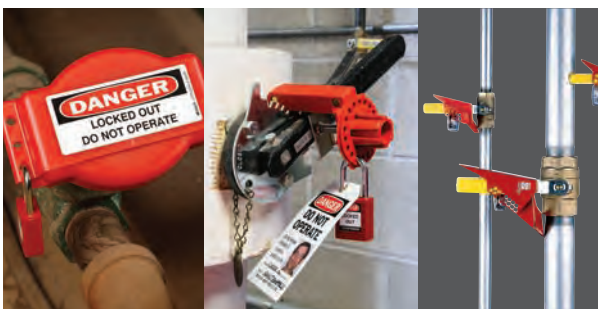

## CHEMICAL, OIL AND GAS LOCKOUT

Valve lockouts for isolation points.



## MANUFACTURING LOCKOUT

Push button and emergency lockout prevents activation of the button or switch.

## Need More Information?

To learn more about implementing an effective, sustainable lockout tagout program refer to **The Safety Professional's Expanded Guide to Lockout Tagout**.



Get your free copy today at:  
[www.bradyid.com.au/LOTOGuide](http://www.bradyid.com.au/LOTOGuide)



# Workplace Safety Directory



Brady is dedicated to helping you reduce injuries in your workplace and meet specific regulatory and compliance requirements. A continued focus on workplace safety allows companies to experience improvements in operational efficiency, reduce lost-time injuries and manage risk.

Every effort has been applied to the accuracy of printed content at the time of publication and is subject to change. The content is provided as a general recommendation and should not be used as a substitute for information provided by your local State or Territory Work Health and Safety regulatory authority. For more information contact your local regulatory authority.

## SAFework NSW

- ▶ **WEB:** [www.safework.nsw.gov.au](http://www.safework.nsw.gov.au)
- ▶ **PHONE:** 13 10 50

## WORKSAFE QUEENSLAND

- ▶ **WEB:** [www.worksafe.qld.gov.au](http://www.worksafe.qld.gov.au)
- ▶ **PHONE:** 1300 362 128

## WORKSAFE ACT

- ▶ **WEB:** [www.worksafe.act.gov.au](http://www.worksafe.act.gov.au)
- ▶ **PHONE:** 13 22 81

## NT WORKSAFE

- ▶ **WEB:** [www.worksafe.nt.gov.au](http://www.worksafe.nt.gov.au)
- ▶ **PHONE:** 1800 019 115
- ▶ **EMAIL:** [ntworksafe@nt.gov.au](mailto:ntworksafe@nt.gov.au)

## WORKSAFE TASMANIA

- ▶ **WEB:** [www.worksafe.tas.gov.au](http://www.worksafe.tas.gov.au)
- ▶ **PHONE:** 1300 366 322
- ▶ **EMAIL:** [wstinfo@justice.tas.gov.au](mailto:wstinfo@justice.tas.gov.au)

## WORKSAFE VICTORIA

- ▶ **WEB:** [www.worksafe.vic.gov.au](http://www.worksafe.vic.gov.au)
- ▶ **PHONE:** (03) 9641 1444 or 1800 136 089 (toll free)
- ▶ **EMAIL:** [info@worksafe.vic.gov.au](mailto:info@worksafe.vic.gov.au)

## WORKSAFE WA

- ▶ **WEB:** [www.commerce.wa.gov.au/worksafe](http://www.commerce.wa.gov.au/worksafe)
- ▶ **PHONE:** 1300 307 877

## SAFework SA

- ▶ **WEB:** [www.safework.sa.gov.au](http://www.safework.sa.gov.au)
- ▶ **PHONE:** 1300 365 255
- ▶ **EMAIL:** [help.safework@sa.gov.au](mailto:help.safework@sa.gov.au)

## SAFE WORK AUSTRALIA

- ▶ **WEB:** [www.safeworkaustralia.gov.au](http://www.safeworkaustralia.gov.au)
- ▶ **EMAIL:** [info@swa.gov.au](mailto:info@swa.gov.au)

## STANDARDS AUSTRALIA

- ▶ **WEB:** [www.standards.org.au](http://www.standards.org.au)
- ▶ **PHONE:** 1800 035 822  
(or +61 2 9237 6171 outside Australia)

## WORKSAFE NEW ZEALAND

- ▶ **WEB:** [www.worksafe.govt.nz](http://www.worksafe.govt.nz)
- ▶ **PHONE:** 0800 030 040
- ▶ **EMAIL:** [info@worksafe.govt.nz](mailto:info@worksafe.govt.nz)

## STANDARDS NEW ZEALAND

- ▶ **WEB:** [www.standards.govt.nz](http://www.standards.govt.nz)
- ▶ **PHONE:** 0800 782 632  
(or +64 4 498 5990 outside New Zealand)
- ▶ **EMAIL:** [enquiries@standards.govt.nz](mailto:enquiries@standards.govt.nz)

### DISCLAIMER:

Every effort has been applied to the accuracy of printed content at the time of publication (February 2017) and is subject to change after this date. The content is provided as a general recommendation and should not be used as a substitute for information provided by your local State or Territory Work Health and Safety regulatory authority.





Lockout Tagout

# Products





The world leader in lockout tagout products and services, Brady offers a broad range of durable, easy-to-use lockout devices that cover most mechanical and electrical applications. Brady's services help companies with limited resources quickly get their program up to speed, ensuring that lockout activities are implemented in a way that promotes optimum safety while maximising efficiency and reducing downtime.



# BRADY SAFETY PADLOCKS

Safety padlocks protect workers from hazardous energy during equipment maintenance activities. Padlocks will keep important energy source points locked and improve safety. Brady's range of padlocks can also withstand harsh environments. Available in a wide range of colour and size options, simply select the padlock to best suit your specific lockout program requirements and applications. Custom keying options are also available on request.

## Brady Safety Plus™ Padlocks



| DIMENSIONS |      |        |
|------------|------|--------|
|            |      |        |
| 38mm       | 85mm | 18mm   |
|            |      |        |
| 20mm       | 38mm | 6.35mm |



### IDEAL APPLICATION:

Mining, manufacturing, electrical, mineral processing, confined spaces, food and beverage.



Custom padlocks can be ordered. Contact your local Brady distributor.

Brady Safety Plus is designed exclusively for use in lockout applications, with the main feature being a 100% non-conductive body which protects workers and equipment. Durable and lightweight design meets WH&S lockout requirements and is well suited for use in harsh industrial environments and extreme temperatures. All Brady Safety Plus Padlocks are supplied with 2 keys and padlock labels. Available Keying Options: Keyed Differently (KD), Keyed Alike (KA), Keyed Alike Master Key and Keyed Differently Master Key.

- ▶ Non-conductive spark resistant body enhances safety in electrical applications
- ▶ One piece lightweight plastic body for maximum durability
- ▶ Steel shackle for worker and equipment protection
- ▶ 53 Nm torsion strength ensures the security of your padlock
- ▶ Corrosion and chemical resistant suitable for harsh environments
- ▶ 6 pin patented keyway delivers optimum security and tamper proofing
- ▶ Key retaining safety feature prevents key from being removed until closed
- ▶ Ribbed padlock body to improve handling whilst wearing gloves

**BODY DIMENSIONS:** 38 x 44 x 18mm (WxHxD)

**SHACKLE DIMENSIONS:** 38 x 6.35mm (L x Dia)

**STANDARD PACKAGE:** 1



| PART NO. | COLOUR          |
|----------|-----------------|
| 850821   | Red             |
| 850816   | Blue            |
| 850818   | Green           |
| 850820   | Yellow          |
| 850819   | Orange          |
| 850817   | Black           |
| 853203   | White           |
| 853204   | Purple          |
| 51379    | Labels - Pack 6 |

For keyed alike or master keyed options please contact your local Brady Distributor for a quote.



# Brady Compact Padlocks

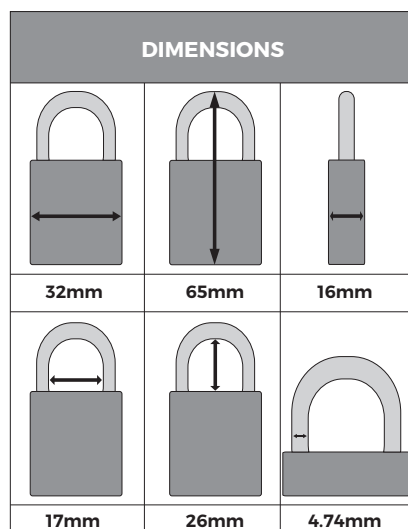
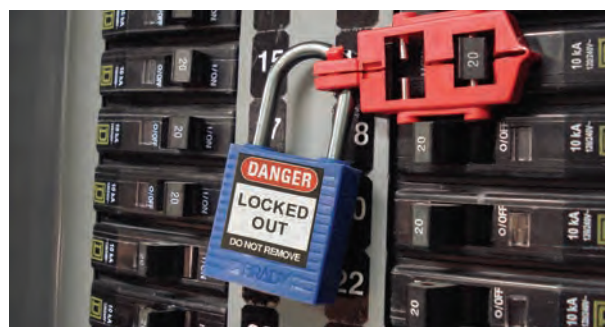
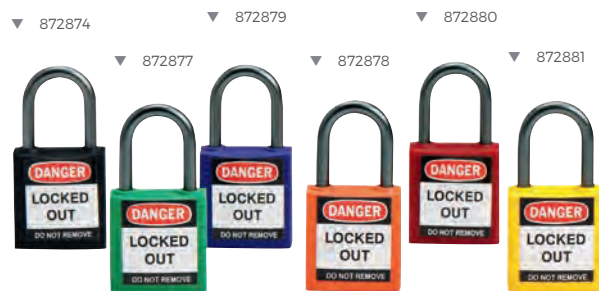

Designed specifically for use in electrical lockout applications, the Brady Compact Lockout Padlocks help keep workers safe and equipment free from damage. Rugged yet compact and lightweight, these innovative locks meet WH&S lockout requirements and are well suited for harsh industrial environments.

The non-conductive, spark resistant body enhances safety in electrical applications while its small body size and shackle diameter makes it perfect for use on ever shrinking lockout devices. The precision machined cylinder offers more unique key cuts and better tamper resistance, with custom keying options also available.

- ▶ Lightweight one piece construction, padlock weighs only 20 grams
- ▶ Non-conductive spark resistant body enhances safety in electrical applications
- ▶ Constructed of rugged reinforced nylon with aluminium shackle
- ▶ Corrosion and chemical resistant suitable for harsh environments
- ▶ 5 pin patented keyway delivers optimum security and tamper proofing
- ▶ Key retaining safety feature prevents key from being removed until closed
- ▶ Supplied with two keys, DANGER and PROPERTY OF labels
- ▶ Custom keying, charting and engraving are also available
- ▶ Insulated key chamber protects workers from shock when the key is inserted

**BODY DIMENSIONS:** 32 x 34 x 16mm (WxHxD)

**SHACKLE DIMENSIONS:** 26 x 4.74mm (L x Dia)

**STANDARD PACKAGE:** 1



## IDEAL APPLICATION:

Confined spaces, mining, electrical, food and beverage.



| PART NO. | COLOUR |
|----------|--------|
| 872880   | Red    |
| 872874   | Black  |
| 872875   | Blue   |
| 872881   | Yellow |
| 872876   | Grey   |
| 872877   | Green  |
| 872878   | Orange |
| 872879   | Purple |
| 872882   | White  |

**NOTE:** Brown available upon request.





# Brady Safety Plus™ Keyed Alike Padlock Pack

▼ 853206



Featuring a premium grade Nylon shackle, these padlocks are ideal for electrical Lockout applications. Available in four colours.

**BODY DIMENSIONS:** 38 x 44 x 18mm (WxHxD)**SHACKLE DIMENSIONS:** 38 x 6.35mm (L x Dia)**STANDARD PACKAGE:** 3

| PART NO. | DESCRIPTION | COLOUR |
|----------|-------------|--------|
| 853205   | Keyed Alike | Red    |
| 853206   | Keyed Alike | Yellow |
| 853207   | Keyed Alike | Blue   |
| 853208   | Keyed Alike | Green  |



**WATCH:**  
[www.bradyid.com.au/videos](http://www.bradyid.com.au/videos)

# Nylon Safety Padlocks With Non-Conductive Nylon Shackle

▼ 872389

▼ 872387



Featuring a premium grade Nylon shackle, these padlocks are ideal for electrical Lockout applications. Available in four colours.

**BODY DIMENSIONS:** 38 x 44 x 18mm (WxHxD)**SHACKLE DIMENSIONS:** 38 x 6.35mm (L x Dia)**STANDARD PACKAGE:** 1

**IDEAL APPLICATION:**  
Electrical lockout.



For custom keying options,  
see pages 18-19

▼ 51379



| PART NO. | DESCRIPTION                        |
|----------|------------------------------------|
| 872386   | Nylon (Keyed Differently) – Red    |
| 872387   | Nylon (Keyed Differently) – Blue   |
| 872388   | Nylon (Keyed Differently) – Green  |
| 872389   | Nylon (Keyed Differently) – Yellow |
| 51379    | Padlock Labels – Pack 6            |

**NOTE:** Other colours available on request.



# Safety Padlocks – Long Body



Brady has launched the long-bodied safety padlock which has a larger information panel on the front and rear of the padlock and provides greater visibility.

**BODY DIMENSIONS:** 40 X 75 X 20mm (WxHxD)

**SHACKLE DIMENSIONS:** 38mm

**STANDARD PACKAGE:** 1



**WATCH:**

[www.bradyid.com.au/videos](http://www.bradyid.com.au/videos)



| PART NO. | DESCRIPTION                                  |
|----------|--|
| 875471   | Brady Long Body (Keyed Differently) - Red    |
| 875475   | Brady Long Body (Keyed Differently) - Yellow |

# Stainless Steel Safety Padlocks

▼ 872390

▼ 872392



▼ 51379



Featuring a premium grade Nylon shackle, these padlocks are ideal for electrical Lockout applications. Available in four colours.

**BODY DIMENSIONS:** 38 x 44 x 18mm (WxHxD)

**SHACKLE DIMENSIONS:** 38 x 6.35mm (L x Dia)

**STANDARD PACKAGE:** 1



**IDEAL APPLICATION:**

Outdoors, damp interiors, corrosive environments.



For custom keying options, see pages 18-19



| PART NO. | DESCRIPTION                  |
|----------|------------------------------|
| 872390   | (Keyed Differently) - Red    |
| 872391   | (Keyed Differently) - Blue   |
| 872392   | (Keyed Differently) - Green  |
| 872393   | (Keyed Differently) - Yellow |
| 51379    | Padlock Labels - Pack 6      |

**NOTE:** Other colours available on request



# Custom Keying Options

Brady are the experts at managing custom keying options. We have many keying options available including thousands of genuine key to differ options and the ability to key alike, master key and grand master key.

## BENEFITS OF HAVING BRADY MANAGE YOUR UNIQUE KEY REGISTER ARE:

1. To ensure there are no duplicate/shadow keys on your premises ensuring the security integrity is managed on-site
2. When you need to build onto your current padlock family with additional products to suit your secured keyway, Brady can assist and make this a quick and easy process.
3. The Brady key register is held in Australia with maximum security to ensure your company's information is secured.
4. Fast and efficient lead times.
5. Provide your company with total asset management control.

## PADLOCK IDENTIFICATION

Brady offers our customers a variety of padlock identification solutions, which include engraving, E-Prep labels and personalised identification cards. Visit [bradyid.com.au](http://bradyid.com.au)



Custom padlocks can be ordered. Contact your local Brady distributor.

## BRADY PADLOCK KEYING OPTIONS



### KEYED DIFFERENTLY

Each lock in a keyed differently system has its own unique key. Guaranteed no duplicates, must be specially requested. See next page if a master key is needed.



### KEYED ALIKE SYSTEMS

All locks in a keyed-alike system use identical keys. Any lock's key can open all the locks within the group.



## MASTER KEYED SYSTEMS

A master key opens all locks in the system, even though each lock has its own individual key. This system permits organising submaster, master and grandmaster systems along departmental or other functional lines. Master keys can also be made to fit multiple groups of Keyed Alike locks. For even greater convenience all custom keying requirements for Brady Lockout Padlocks are keyed locally for faster delivery time.

- ▶ Supervisory master key opens all locks in system
- ▶ Each padlock also opens with an individual key
- ▶ Allows for organising of Grandmaster, Master and Submaster systems.

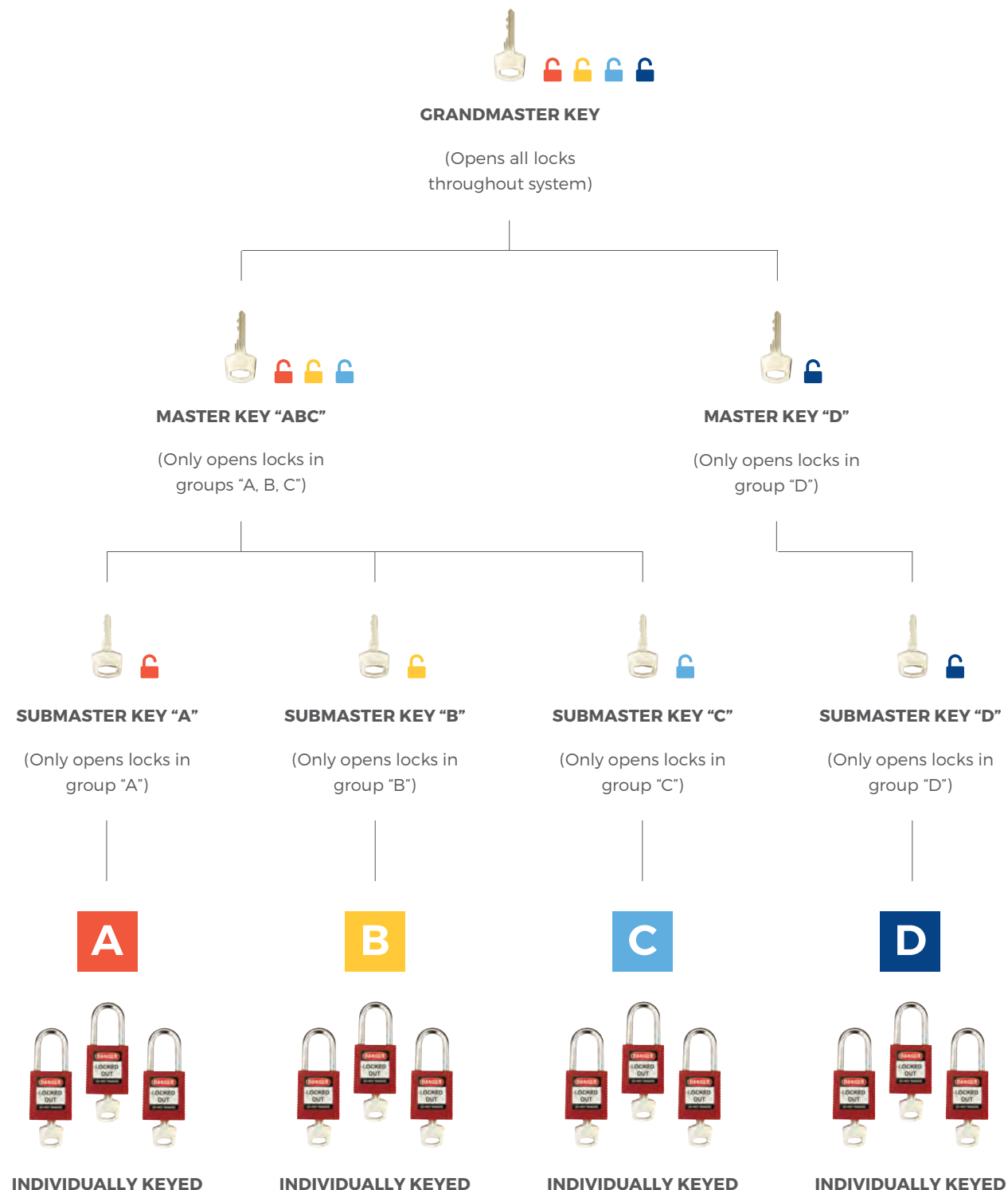





# CIRCUIT BREAKER LOCKOUT DEVICES

Circuit breaker lockout devices work on a wide range of breakers that include single and multi-pole breaker configurations. Snap-on and clamp-on breaker Lockout options accommodate almost any situation. Ensure safe and secure isolation of any switch source with Brady's range of circuit breaker lockout devices.

## Eurasian Miniature Lockouts

▼ 90847



▼ 90850



▼ 90853



▼ 90844



Improve your business's Electrical Lockout Program with these DIN style circuit breaker lockout devices. These devices are easily installed with no tools required and can be partnered with our range of Safety Plus Lockout Padlocks and Hasps to ensure the safety of your workers whilst electrical maintenance or repairs are carried out.

### TIE BAR LOCKOUT (TBLO)

- ▶ Tie Bar style lockout has a convenient thumb wheel
- ▶ Lockouts are available from single and multi-pole breakers
- ▶ Made of glass-filled nylon

### PIN OUT WIDE LOCKOUT (POW) & PIN IN STANDARD LOCKOUT (PIS) & PIN OUT STANDARD LOCKOUT (POS)

- ▶ Easy to install with the aid of a push button
- ▶ Lockouts are available from single and multi-pole breakers
- ▶ Made of glass-filled nylon



Recommended use with Brady Safety Plus Padlocks.



**WATCH:**  
[www.bradyid.com.au/videos](http://www.bradyid.com.au/videos)



| PART NO. | DESCRIPTION                    | QTY |
|----------|--------------------------------|-----|
| 90847    | Pin In Standard Lockout (PIS)  | 1   |
| 90848    | Pin In Standard Lockout (PIS)  | 6   |
| 90850    | Pin Out Wide Lockout (POW)     | 1   |
| 90851    | Pin Out Wide Lockout (POW)     | 6   |
| 90853    | Tie Bar Lockout (TBLO)         | 1   |
| 90854    | Tie Bar Lockout (TBLO)         | 6   |
| 90844    | Pin Out Standard Lockout (POS) | 1   |
| 90845    | Pin Out Standard Lockout (POS) | 6   |





### CIRCUIT BREAKER COMPATIBILITY CHART: 90847 & 90848

| BREAKER BRAND        | NO. OF POLES | BREAKER MODEL NO. | LOCKOUT TYPE |
|----------------------|--------------|-------------------|--------------|
| AEG                  | 2            | E82S              | PIS          |
| E-T-A                | 1            | 911225            | PIS          |
| Kapp                 | 1            | LS68              | PIS          |
| GE Vynckier C16, 16A | 1            | Series E          | PIS          |
| GE Vynckier          | 1            | Series G          | PIS          |
| GE Vynckier 16A      | 2            | Series E          | PIS          |
| GE Vynckier          | 3            | Series E          | PIS          |
| GE Vynckier          | 3            | Series G          | PIS          |
| GE Vynckier          | 4            | Series E          | PIS          |
| Legrand              | 2            | 4302              | PIS          |
| Legrand              | 3            | 6469              | PIS          |
| Sursum               | 3            | EA53              | PIS          |
| Terasazki/NHP        | 1            | C20               | PIS          |

### CIRCUIT BREAKER COMPATIBILITY CHART: 90853 & 90854

| BREAKER BRAND | NO. OF POLES | BREAKER MODEL NO. | LOCKOUT TYPE |
|---------------|--------------|-------------------|--------------|
| Legrand       | 2            | 1935              | TBLO         |
| Legrand       | 3            | 1980              | TBLO         |
| Legrand       | 4            | 1980              | TBLO         |
| Merlin Gerin  | 3            | C80A              | TBLO         |
| Merlin Gerin  | 2            | B100A             | TBLO         |
| Siemens 17U   | 2            | 5SQ12             | TBLO         |
| Siemens L20A  | 3            | 5SN2-2            | TBLO         |
| Siemens C32   | 2            | 5SX1-2            | TBLO         |
| Siemens 17U   | 3            | 5SQ13             | TBLO         |
| Siemens C70   | 3            | 5SX13             | TBLO         |
| Siemens 17U   | 4            | 5SQ16             | TBLO         |



### CIRCUIT BREAKER COMPATIBILITY CHART: 90850 & 90851

| BREAKER BRAND | NO. OF POLES | BREAKER MODEL NO. | LOCKOUT TYPE |
|---------------|--------------|-------------------|--------------|
| Siemens B32   | 1            | 5SX21             | POW          |
| Siemens 17U   | 1            | 5SQ11             | POW          |
| Siemens C10   | 1            | 5SX1              | POW          |
| Merlin Gerin  | 3            | C80A              | POW          |
| Merlin Gerin  | 2            | B100A             | POW          |

### CIRCUIT BREAKER COMPATIBILITY CHART: 90844 & 90845

| BREAKER BRAND | NO. OF POLES | BREAKER MODEL NO. | LOCKOUT TYPE |
|---------------|--------------|-------------------|--------------|
| Allen-Bradley | 1, 2, 3      | 1492-CB1, 2, 3    | POS          |
| ABB           | 1            | S222              | POS          |
| ABB           | 1            | F374              | POS          |
| ABB           | 1            | S251, S261, S263  | POS          |
| ABB           | 1            | S272, S253        | POS          |
| ABB           | 3            | S253              | POS          |
| Buschmat      | 1            | S46               | POS          |
| Clipsal       | 1            | 4CB116            | POS          |
| Clipsal       | 3            | 4CB320            | POS          |
| E-T-A         | 2            | 911220G           | POS          |
| FAZ           | 4            | C16               | POS          |
| FAZ           | 1            | C16               | POS          |
| Hager         | 3            | 453717            | POS          |
| Hager         | 2            | MW216A            | POS          |
| Hager         | 4            | MW620A            | POS          |
| Legrand       | 1            | 1908              | POS          |
| Merlin Gerin  | 1            | C60N              | POS          |
| Merlin Gerin  | 1            | C32N              | POS          |
| Merlin Gerin  | 2            | C60N              | POS          |
| Merlin Gerin  | 4            | C60N              | POS          |
| Merlin Gerin  | 3            | C32N              | POS          |
| Merlin Gerin  | 3            | C45AD             | POS          |
| Proteus       | 1            | C16               | POS          |
| Proteus       | 1            | C6                | POS          |
| Proteus       | 3            | C6                | POS          |
| Wylex         | 2            | WRS40/2           | POS          |



## No Hole Single Pole Circuit Breaker Lockout



Brady patented No Hole lockout device is easy to install using patented thumbscrew design – no screwdrivers needed.

- ▶ Designed to lockout most single pole circuit breakers
- ▶ Enhanced to lockout most Federal Pacific breakers
- ▶ Easy to install simply tighten lockout securely onto switch tongue, pull cover over thumbscrew and lock cover to prevent clamp from being loosened
- ▶ Accepts up to 7mm shackle diameter to lockout
- ▶ Fits wider and thicker switch tongues; 16mm wide x 11mm thick (277 volt device), 41mm wide by 14mm thick (480/600 volt device)



| PART NO. | DESCRIPTION  | QTY |
|----------|--------------|-----|
| 65965    | Small Device | 6   |
| 65396    | Small Device | 1   |
| 65966    | Large Device | 6   |
| 65397    | Large Device | 1   |

## Original Single Pole Circuit Breaker Lockout



This patented device has holes in the switch tongue, our simple snap design is a "snap" to install.

- ▶ Simple design snaps onto breaker switch
- ▶ Locks out most major brand breaker switches (except Federal Pacific and most 277 volt breakers)
- ▶ Accepts up to 7mm shackle diameter Safety Padlock



| PART NO. | QTY |
|----------|-----|
| 65688    | 6   |
| 65387    | 1   |

## Circuit Breaker Lockout



Compact universal design to lockout a large range of single, double and triple-pole circuit breakers. Place lockout over circuit breaker handle, tighten set screw and attach padlock and tag.



| PART NO. | DESCRIPTION             | QTY |
|----------|-------------------------|-----|
| 836597   | Circuit Breaker Lockout | 1   |



# Lockout Cleats

▼ Step 1

▼ Step 2



Used with small and large No Hole breaker lockouts (65965 & 65966).

- ▶ Cleats easily clip onto the bottom of No Hole breaker lockout devices
- ▶ Assures positive restraint for breakers with long sliding switch throws



**WATCH:**  
[www.bradyid.com.au/videos](http://www.bradyid.com.au/videos)



| PART NO. | DESCRIPTION | QTY |
|----------|-------------|-----|
| 65404    | Small Pack  | 6   |
| 65406    | Large Pack  | 6   |

# Universal Multi-Pole Breaker Lockout



Patented Multi-Pole lockout works with most major multi-pole breakers with tie-bar.

- ▶ Convenient as no self-locking tie is needed
- ▶ Compatible with: GE, I-T-E, Sylvania, Challenger, Bryant, Westinghouse and General Switch Co.
- ▶ Made of durable impact modified nylon



**WATCH:**  
[www.bradyid.com.au/videos](http://www.bradyid.com.au/videos)



| PART NO. | QTY |
|----------|-----|
| 66320    | 6   |
| 66321    | 1   |

# Oversized Clamp Breaker Lockout



Oversized lockout fits breakers up to 63mm wide by 22mm thick. Made of durable polypropylene and glass filled impact-modified nylon.



| PART NO. | QTY |
|----------|-----|
| 65321    | 6   |
| 65329    | 1   |



# TAGLOCK® Circuit Breaker

▼ 148689  
148693



▼ 148696  
148688



▼ 148690  
148698



▼ 148701  
148687



▼ 148702  
148697



▼ 148692  
148691



Step up safety and compliance with physically secure tagout for up to four workers. With Brady's TAGLOCK™ circuit breaker securing devices, your maintenance team members can individually tag and secure each circuit breaker for improved safety and compliance. These devices are secured to circuit breakers with standard non-releasable 50-pound minimum strength nylon cable ties.

## TAGLOCK SECURING DEVICES FEATURE:

- ▶ Easy installation onto the breaker with nylon cable tie and the worker's ID tag
- ▶ Multiple worker tagging capabilities for up to 4 workers to apply a nylon cable tie and their ID tag
- ▶ Secure restraints that will remain securely fastened to the breaker switch until each person has removed their nylon cable tie and tag
- ▶ Pre-loadable tags enable users to prepare ID tags in advance and then quickly secure them to the designated energy control lockout points
- ▶ More convenient lockout tagout option eliminates the need to use locks
- ▶ Cost savings when it comes to tag preparation and reduced equipment downtime
- ▶ Made from Polypropylene; Fiberglass Reinforced Nylon and available in single or packs of 6



| PART NO. | DESCRIPTION  | QTY | DIMENSIONS (W X H X D) | MAX SHACKLE DIAMETER | VALVE HANDLE DIAMETER | TYPE OF DEVICE                     |
|----------|--|-----|------------------------|----------------------|-----------------------|------------------------------------|
| 148689   | Taglock Snap-On Circuit Breaker Lo                 | 1   | 25 x 22 x 67mm         | 71mm                 | 12mm / 16mm           | Single-Pole Circuit Breaker        |
| 148693   | Taglock Snap-On Circuit Breaker Lo Pack 6          | 6   | 25 x 22 x 67mm         | 71mm                 | 12mm / 16mm           | Single-Pole Circuit Breaker        |
| 148696   | Taglock Switch with Hole Circuit Breaker Lo        | 1   | 19 x 15 x 64mm         | 71mm                 | 12mm                  | Single-Pole Circuit Breaker        |
| 148688   | Taglock Switch with Hole Circuit Breaker Lo Pack 6 | 6   | 19 x 15 x 64mm         | 71mm                 | 12mm                  | Single-Pole Circuit Breaker        |
| 148690   | Taglock 120/277V Clamp-On Breaker Lo               | 1   | 25 x 34 x 48mm         | 71mm                 | 16mm                  | Single-Pole Circuit Breaker        |
| 148698   | Taglock 120/277V Clamp-On Breaker Lo Pack 6        | 6   | 25 x 34 x 48mm         | 71mm                 | 16mm                  | Single-Pole Circuit Breaker        |
| 148701   | Taglock 480/600V Clamp-On Breaker Lo               | 1   | 56 x 43 x 76mm         | 71mm                 | 41mm                  | Single-Pole Circuit Breaker        |
| 148687   | Taglock 480/600V Clamp-On Breaker Lo Pack 6        | 6   | 56 x 43 x 76mm         | 71mm                 | 41mm                  | Single-Pole Circuit Breaker        |
| 148702   | Taglock Multipole Circuit Breaker Lo               | 1   | 33 x 38 x 57mm         | 71mm                 | n/a                   | Multi-Pole Tie Bar Circuit Breaker |
| 148697   | Taglock Multipole Circuit Breaker Lo Pack 6        | 6   | 33 x 38 x 57mm         | 71mm                 | n/a                   | Multi-Pole Tie Bar Circuit Breaker |
| 148692   | Taglock Oversized Circuit Breaker Lo               | 1   | 95 x 76 x 101mm        | 71mm                 | 70mm                  | Oversized Circuit Breaker          |
| 148691   | Taglock Oversized Circuit Breaker Lo Pack 6        | 6   | 95 x 76 x 101mm        | 71mm                 | 70mm                  | Oversized Circuit Breaker          |



# Breaker Lockouts

▼ BL01



▼ BL03



▼ BL04



▼ BL07



Our Patented devices allow circuit breakers to be locked out, preventing energisation of electric currents.

- ▶ Made from tough polycarbonate material
- ▶ Single pole breaker lockout (BL01) is designed to fit most single pole breaker applications
- ▶ Multi pole breaker lockout (BL03) is designed to fit multi breakers
- ▶ No Hole circuit breaker lockout (BL04) is designed to fit circuit breaker toggles up to 13mm wide without a recess hole in the toggle
- ▶ Three phase breaker lockout (BL07) is designed to lockout a wide range of three phase breaker handles up to 20mm thick and 76mm wide



| PART NO. | DESCRIPTION                       | QTY |
|----------|-----------------------------------|-----|
| BL01     | Single Pole Breaker Lockout       | 1   |
| BL03     | Multi-Pole Breaker Lockout        | 1   |
| BL04     | "No Hole" Circuit Breaker Lockout | 1   |
| BL07     | Three Phase Breaker Lockout       | 1   |



**WATCH:**

[www.bradynid.com.au/videos](http://www.bradynid.com.au/videos)

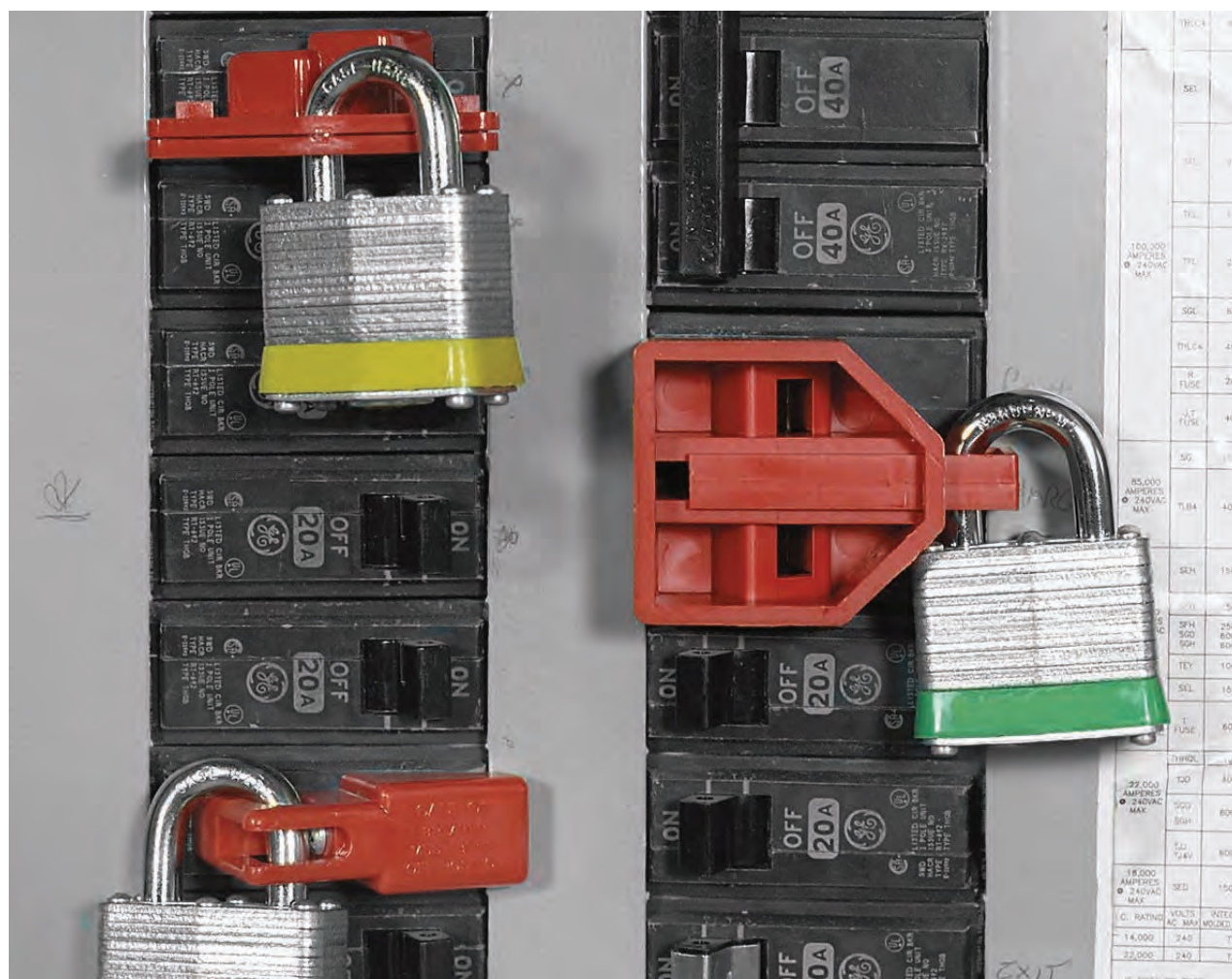



# VALVE LOCKOUTS

Valve lockout devices are the safe way to secure valves and control potential hazards from fluids, gas and steam. To prevent injuries it is imperative that valves are isolated prior to any maintenance. Brady's range of valve lockout devices are available in various adjustable and universal options for additional flexibility.

## Transparent Gate Valve Lockout



New Brady Transparent Gate Valve Lockouts offer a clear advantage to traditional gate valve lockout devices. These see-through valve lockout devices provide a safer, more visual solution, allowing workers to visually confirm correct handle positions and identify any valve leakage – all without having to remove the device from the locked-out state.

### FEATURES:

- ▶ Fits OS&Y or “rising stem” valves with five different size options
- ▶ Tough thermoplastic construction for durability
- ▶ Excellent chemical resistance to withstand corrosive environments
- ▶ Supplied with English, Spanish and French “DANGER LOCKED OUT” labels

**COLOUR:** Transparent

**MATERIAL:** Polycarbonate

**APPROVAL/COMPLIANCE:** OSHA 1910.147

**MAX. SERVICE TEMP:** 115°C

**MIN. SERVICE TEMP:** -40°C

**MAX. SHACKLE DIAMETER:** 9.7mm

**MIN. SHACKLE CLEARANCE :** 19mm

**STANDARD PACKAGE:** 1



| PART NO. | HAND WHEEL DIAMETER (MM) | HOLE DIAMETER (MM) | DIAMETER (MM) | DEPTH (MM) | HEIGHT (MM) | WIDTH (MM) |
|----------|--------------------------|--------------------|---------------|------------|-------------|------------|
| 145581   | 25-64                    | 19                 | 70.6          | 35.9       | 80          | 120.1      |
| 145582   | 64-127                   | 44.5               | 132.3         | 50.6       | 141.7       | 184.8      |
| 145583   | 127-165                  | 63.5               | 171.4         | 60.4       | 181         | 224.1      |
| 145584   | 165-254                  | 89.4               | 276.2         | 76.2       | 276.2       | 318.3      |
| 145585   | 254-330                  | 104.5              | 354.5         | 76.2       | 363.5       | 405.1      |





# Adjustable Gate Valve Lockout



Eliminate the need to buy 3 or more lockouts. The adjustable gate valve lockout adjusts to fit multiple size gates.

- ▶ The durable polypropylene construction resists cracking and abrasion and can withstand temperatures from -20°C to 80°C
- ▶ Designed to completely enclose the handle and prevent tampering
- ▶ Device is compact for easy carrying and storage
- ▶ Available in red or yellow
- ▶ Labels included, also sold separately

**STANDARD PACKAGE: 1**



| PART NO. | COLOUR |
|----------|--------|
| 850835   | Yellow |
| 850834   | Red    |
| 851649   | Label  |

## Gate Valve Lockouts



Makes locking out valves safe and easy with the Brady Gate Valve Lockouts.

- ▶ Made of durable, non-adherent plastic to resist chemicals and hot and cold temperatures
- ▶ Stainless steel hinge design for added strength and durability
- ▶ Unique knockout feature accommodates OS&Y or "rising stem" gate valves
- ▶ Designed to accept all locks with up to 9.4mm shackle diameter and 19mm or greater vertical shackle clearance for a great variety of applications
- ▶ Available in five sizes to fit valve handles from 25mm up to 330mm in diameter
- ▶ Green is frequently used to indicate if valve is locked in open or Red closed position

**STANDARD PACKAGE: 1 Device, Labels included.**



| VALVE HANDLE DIAMETER | RED   | YELLOW | GREEN | BLUE  |
|-----------------------|-------|--------|-------|-------|
| 25mm to 63mm          | 65560 | 65590  | 65595 | 65585 |
| 63mm to 125mm         | 65561 | 65591  | 65596 | 65586 |
| 125mm to 162mm        | 65562 | 65592  | 65597 | 65587 |
| 162mm to 250mm        | 65563 | -      | 65598 | 65588 |
| 250mm to 330mm        | 65564 | 65594  | 65599 | -     |





## Ball Valve Lockout



Patented design and ultra tough polypropylene makes these ball valve lockouts the best you can buy.

- ▶ Available in two sizes the small lockout pipe locks 13mm to 64mm in diameter and the large locks out pipes 51mm to 203mm in diameter
- ▶ The small lockout can also be used to lock valves in the open position on pipes 13mm to 32mm in diameter
- ▶ Available in four colours: red, blue, green and yellowkeys, locks etc inside

### STANDARD PACKAGE: 1



| PART NO. | DESCRIPTION                       |
|----------|-----------------------------------|
| BS07A    | Small Ball Valve Lockout - Red    |
| BS08A    | Large Ball Valve Lockout - Red    |
| BS07A-BU | Small Ball Valve Lockout - Blue   |
| BS08A-BU | Large Ball Valve Lockout - Blue   |
| BS07A-GN | Small Ball Valve Lockout - Green  |
| BS08A-GN | Large Ball Valve Lockout - Green  |
| BS07A-YW | Small Ball Valve Lockout - Yellow |
| BS08A-YW | Large Ball Valve Lockout - Yellow |

## Perma-Mount Ball Valve



- ▶ Device permanently mounted at point of energy isolation
- ▶ Securely retains the operating handle in the 90° fully closed position
- ▶ Two sizes to fit 10-100mm and 63-102mm
- ▶ Durable construction to withstand a wide range of environmental conditions

### STANDARD PACKAGE: 1



| PART NO. | DESCRIPTION                                  |
|----------|--|
| 121540   | Small Perma-mount Ball Valve (fits 12-51mm)  |
| 121541   | Large Perma-mount Ball Valve (fits 63-102mm) |

# Universal Valve Lockout



◀ No need for multiple types and sizes of lockouts – now one device does it all!



◀ Clamp attaches to butterfly handles, preventing trigger handle from being squeezed. Valve cannot be repositioned!



◀ Use blocking arm to lockout quarter-turn ball valves.



◀ Use cable attachment to lock out gate valves.



◀ Use two blocking arms to lockout 3, 4 or 5-way valves, or to lock valves in the throttled position for operational control.

No need to have multiple types and lockout devices, now one device fits them all.

- ▶ Perform multiple valve lockouts with just one device
- ▶ This device has an open ended clamp that fits over closed rings and wide handles
- ▶ The device can be used to lock large levers, T handles and other hard to secure mechanical devices
- ▶ Made of industrial grade steel and nylon for extra impact and chemical resistance
- ▶ Available in two sizes small and large
- ▶ Choose between a 2.4m non-conductive nylon cable or a 2.4m sheathed steel cable (cables sold separately)
- ▶ Small Universal Valve Lockout device fits handle size 25.4mm x 15mm (WxH).
- ▶ Large Universal Valve Lockout device fits handle size 40mm x 27.5mm (WxH).



Lock out all types of valves with a single device



**WATCH:**  
[www.bradynid.com.au/videos](http://www.bradynid.com.au/videos)

## STANDARD PACKAGE: 1

### UNIVERSAL VALVE LOCKOUT: Complete Sets



| PART NO. | DESCRIPTION   |
|----------|---|
| 51394    | Small UVLO w/ 2.4m Sheathed Cable Attachment & Blocking Arm |
| 51390    | Small UVLO w/ 2.4m Nylon Cable Attachment & Blocking Arm    |
| 51392    | Large UVLO w/ 2.4m Sheathed Cable Attachment & Blocking Arm |
| 51388    | Large UVLO w/ 2.4m Nylon Cable Attachment & Blocking Arm    |

## STANDARD PACKAGE: 1

### UNIVERSAL VALVE LOCKOUT: Individual Components



| PART NO. | DESCRIPTION                             |
|----------|---|
| 50924    | Small UVLO Base Clamping Unit           |
| 50899    | Large UVLO Base Clamping Unit           |
| 65402    | Small Blocking Arm                      |
| 65403    | Large Blocking Arm                      |
| 51395    | Cable Attachment w/ 2.4m Sheathed Cable |
| 50932    | Cable Attachment w/ 2.4m Nylon Cable    |





# CABLE LOCKOUTS

Lockout cables provide solutions for locking out gate valves, handles and other oversized devices that are difficult to lock using conventional means. These lockouts are ideal for a variety of applications with different size cable lengths available allowing you to lockout multiple valves at the same time.

## SAFELEX™ Universal Cable Lockout



Safely secure multiple energy disconnects with this versatile group lockout device. SAFELEX™ Universal Cable Lockout is now available with a nonconductive red nylon cable that is ideal for electrical shutoff points and corrosive environments. The SAFELEX cable can be tightened to remove unwanted slack even after the body is pivoted to the locking position.

- ▶ Integrated hasp and cable provides an optimal way to lock out multiple energy isolation points
- ▶ Cable can still be tightened even after the hasp is locked
- ▶ Available in a variety of cable lengths and materials
- ▶ New nylon cable model ensures non-conductivity for electrical applications
- ▶ Effective lockout with up to 6 safety padlocks on the SAFELEX hasp-shaped body
- ▶ Lightweight construction for improved handling and storage

### STANDARD PACKAGE: 1



| PART NO. | CABLE LENGTH | CABLE MATERIAL |
|----------|--------------|----------------|
| 145550   | 1.8m         | Nylon          |
| 145549   | 3m           | Nylon          |
| 145554   | 900mm        | Sheathed Steel |
| 145553   | 1.8m         | Sheathed Steel |
| 145552   | 3m           | Sheathed Steel |
| 145551   | 4.5m         | Sheathed Steel |





# Original Cable Lockout



The original Cable lockout device enables you to lockout several disconnects in various energy distribution centres simultaneously.

- ▶ Flexible cable lockout devices can be used to lockout multiple valves at the same time
- ▶ Better than chains and more effective with a lot less weight
- ▶ A cost effective way to lockout gate valves with many other uses as well
- ▶ Great for security use too

## STANDARD PACKAGE: 1



We recommend using a Safety Plus Padlock with the Cable Lockouts to ensure the device is secured effectively.



**WATCH:**  
[www.bradynid.com.au/videos](http://www.bradynid.com.au/videos)



## CABLE LOCKOUT DEVICE



| PART NO. | DESCRIPTION |
|----------|-------------|
| 65318    | 1.8m Cable  |

## ADDITIONAL CABLES



| PART NO. | DESCRIPTION |
|----------|-------------|
| 65319    | 2.4m Cable  |
| 65320    | 3.0m Cable  |





# All Purpose Cable Lockout



These flexible all purpose cables can be used in a variety of applications and can secure unusual energy isolating devices that are difficult to lockout using conventional means.

- ▶ Ergonomic design makes it a breeze to tighten
- ▶ Using the cable hold device in one hand, cinch the cable tight with the other
- ▶ Lightweight body is made of impact modified glass filled nylon
- ▶ Built-in loops keep cable neatly coiled when stored and also keeps excess cable from dangling loose and posing a hazard when in use
- ▶ Available in 2 types of cables which are interchangeable and can be purchased separately



**WATCH:**

[www.bradyid.com.au/videos](http://www.bradyid.com.au/videos)

**STANDARD PACKAGE: 1**

## NON CONDUCTIVE NYLON CABLES



| PART NO. | DESCRIPTION        |
|----------|--------------------|
| 50945    | Nylon Cable - 2.4m |
| 50948    | Nylon Cable - 3.6m |
| 50951    | Nylon Cable - 4.8m |
| 50954    | Nylon Cable - 6.0m |

## METAL CABLES



| PART NO. | DESCRIPTION           |
|----------|-----------------------|
| 50947    | Sheathed Cable - 2.4m |
| 50950    | Steel Cable - 3.6m    |
| 50953    | Steel Cable - 4.8m    |
| 50956    | Steel Cable - 6.0m    |

## CABLE LOCKOUT DEVICE



| PART NO. | DESCRIPTION                    |
|----------|--------------------------------|
| 50941    | APCLO with 2.4m Nylon Cable    |
| 50943    | APCLO with 2.4m Sheathed Cable |
| 50944    | APCLO without Cable            |



# ELECTRICAL EQUIPMENT LOCKOUT

Electrical lockout equipment will help you properly shut down electrical systems and help you avoid accidents during maintenance programs. Ideal for push buttons, large and small plugs these visual lockouts ensure that equipment is not restarted unexpectedly.

## Twist and Secure Push Button and E-Stop Safety Covers

▼ 130822

▼ 134018

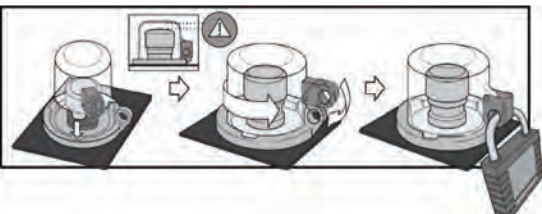
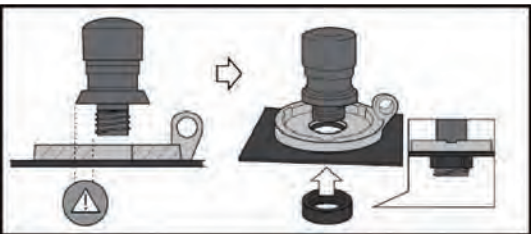

Safety cover devices are designed to temporarily prevent access to the ON/OFF switch and stop controls. They provide fast and effective securing of facility production and operating equipment by authorised workers.

- ▶ Provides universal safety coverage for each of the three standard control button stem/panel diameters (16mm, 22mm and 30mm)
- ▶ One time installation of the low profile, unobtrusive safety cover base
- ▶ Standardised bases allow workers to simply twist a safety cover into place over any equipment control buttons that are fitted with permanently placed safety cover bases; then secure with a Lockout padlock



### IDEAL APPLICATION:

General manufacturing, food and beverage, chemical allied processing, oil and gas refining, pulp and paper, construction, mining, healthcare and education labs and facility operating equipment.



We recommend using a Safety Plus Padlock with the Push Button Safety Cover. See page 14.



| PART NO. | DESCRIPTION                                    | QTY    |
|----------|--|--------|
| 134018   | 16mm Push Button Lo Device with Standard Cover | 1      |
| 130819   | 16mm Push Button Lo Device with Tall Cover     | 1      |
| 130820   | 22mm Push Button Lo Device with Standard Cover | 1      |
| 130821   | 30mm Push Button Lo Device with Standard Cover | 1      |
| 130822   | 16mm Push Button/E-Stop Lo Bases               | 5 Pack |
| 130823   | 22mm Push Button/E-Stop Lo Bases               | 5 Pack |
| 130824   | 30mm Push Button/E-Stop Lo Bases               | 5 Pack |



## Standard Plug Lockout



The Plug lockout is ideal for those situations where the plug is not under the exclusive control of the worker performing the service or maintenance

- ▶ The Plug lockout prevents another worker from putting the plug back into its outlet
- ▶ DANGER message printed on device to alert workers of lockout in progress
- ▶ Designed for heavy duty applications
- ▶ Made of tough polypropylene
- ▶ A cost effective way to safely lockout electrical plugs
- ▶ Available in 2 sizes; small accepts up to 12.7mm cord and large accepts up to 25.5mm cord



We recommend using a Safety Plus Padlock (See page 14) with your Plug Lockout for a total lockout solution.



**WATCH:**  
[www.bradyid.com.au/videos](http://www.bradyid.com.au/videos)

### STANDARD PACKAGE: 1



| PART NO. | DESCRIPTION                  | DIMENSIONS (L X H X D) |
|----------|------------------------------|------------------------|
| 65674    | Small - 3 Pin Standard Plugs | 89 x 50 x 50mm         |
| 65675    | Large - Industrial Plugs     | 178 x 82 x 82mm        |

## 3-In-1 Plug Lockout



Accommodates high and low voltage plugs.

- ▶ Two sliding top lids can be used individually or together to accommodate small, medium and large diameter cords up to 31mm
- ▶ Accommodates plugs up to 76mm in diameter and 139mm in length
- ▶ Suitable for Three Phase lockout

### STANDARD PACKAGE: 1



| PART NO. | DESCRIPTION                   |
|----------|-------------------------------|
| PL023    | 3-in-1 Plug Lockout - English |

# LOCKOUT HASPS

Lockout hasps ensure the energy source stays locked out until every individual working on the repairs or inspection is finished. Each worker involved in the process puts a lock on the hasp but the hasp cannot be removed until all locks have been removed. Ideal for group lockout programs where visibility to the energy source is important.

## Safety Lockout Hasp



Allows for up to 6 workers to lockout a single point.

- ▶ Vinyl coated high tensile steel plated to resist rust
- ▶ Accepts up to 6 padlocks up to 9mm shack diameter



| PART NO. | JAW DIAMETER | PACK SIZE |
|----------|--------------|-----------|
| 65375    | 25mm         | 12        |
| 65375/1  | 25mm         | 1         |
| 65376    | 38mm         | 12        |
| 65376/1  | 38mm         | 1         |

## Dual-Size Lockout Hasp



Constructed of case hardened plated steel and insulated with red vinyl coating.

- ▶ Each hasp will hold up to six padlocks
- ▶ Wide and narrow jaws on the same device makes this ideal for varying lockout applications



| PART NO. | QTY |
|----------|-----|
| 834192   | 12  |
| 834192/1 | 1   |





## High Visibility Lockout Hasp



High Visibility Lockout Hasps have a bright yellow plastic coating that can be seen from a distance.

- ▶ Durable epoxy coated steel provides resistance to rust while adding dielectric strength
- ▶ Yellow plastic coating prevents hasp from scratching machinery
- ▶ Each hasp holds up to six padlocks with a lock hole diameter up to 9mm

**STANDARD PACKAGE: 1**



| PART NO. | JAW DIAMETER |
|----------|--------------|
| 846674   | 25.5mm       |
| 846676   | 38mm         |

## Non-Conductive Hasp



These harps are non-conductive and suitable for use where electrical current may occur.

- ▶ Easily identifiable fluorescent orange
- ▶ Lightweight lockouts are easily carried
- ▶ Lockout measures 25 x 64mm and allows the use up to six padlocks



Ideal to use with a Safety Plus Padlocks.  
See page 14

**STANDARD PACKAGE: 1**



| PART NO. | DESCRIPTION          |
|----------|----------------------|
| 844501   | Non-Conductive Hasps |

# Standard Lockout Hasp



Durable steel hasp.

- ▶ Available in 25mm hasp and 10mm holes
- ▶ Accommodates up to six padlocks
- ▶ Economical and easy to use



| PART NO. | JAW DIAMETER | QTY |
|----------|--------------|-----|
| 834193   | 25mm         | 12  |

# Dual Level Safety Lockout

▼ 873384

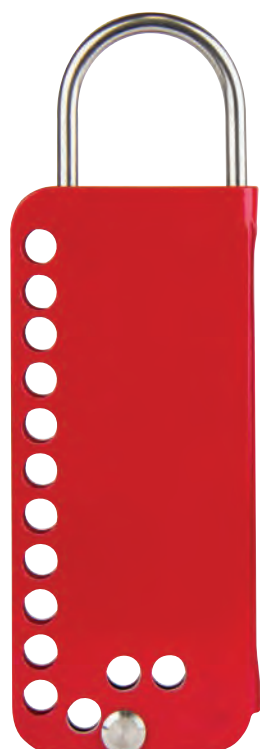

▼ 852439



Especially designed to allow for the removal of personal padlocks. This lockout enables a supervisory padlock (2 padlocks on the 12 hole) to remain safely locked in place to ensure the machine remains isolated.

- ▶ Fool proof access to the hasp entry and a tamperproof locking facility adds additional safety
- ▶ Manufactured from marine grade 316 stainless steel for maximum performance
- ▶ The lockout has a 5.7mm hasp shank that will fit most electrical switch gear, cabinets and distribution boards
- ▶ Available in 6 hole x 1 supervisory or 12 hole x 2 supervisory configurations

**STANDARD PACKAGE: 1**



| PART NO. | DESCRIPTION                       |
|----------|-----------------------------------|
| 852439   | Dual Level 6 Hole Safety Lockout  |
| 873384   | Dual Level 12 Hole Safety Lockout |







# GROUP LOCK BOXES

Group lock boxes are a great solution for isolating energy points when a large team is working. Using a group lockout box allows you to limit weight on each energy point to just a supervisor isolation and provides a quick overview of who is still working without going to each energy point. Brady's range of lock boxes are available in different styles and colours to meet your maintenance program requirements.

## Group Lock Box



Group Lock boxes require fewer locks and are lighter than hasps on delicate energy isolating devices like circuit breakers.

- ▶ Our portable metal lock box is made from heavy duty steel and is powder coated for extra rust resistance
- ▶ Accepts 13 individual locks and is available in red or blue
- ▶ The extra large Group Lock Box accommodates 12 padlocks with enough internal space to accommodate up to 75 padlocks

### STANDARD PACKAGE: 1



| PART NO. | DIMENSIONS (W X H X D) | COLOUR |
|----------|------------------------|--------|
| 65699    | 250 x 150 x 100mm      | Red    |
| 45190    | 250 x 150 x 100mm      | Blue   |

## Lock Box with Window



Similar to the Lock Box with the additional feature of the window provides visibility of contents.

- ▶ Allows one worker to control lockouts of all other team members
- ▶ After machine or process is locked out, all keys are placed in lock box
- ▶ Group leaders place lock on lock box until job is complete and all group members are cleared from work area
- ▶ Constructed from heavy duty steel

### STANDARD PACKAGE: 1



| PART NO. | DIMENSIONS (W X H X D) | COLOUR | WEIGHT |
|----------|------------------------|--------|--------|
| 848018   | 250 x 150 x 100mm      | Blue   | 1.7kg  |

\*Padlocks and Hasp not included.



## Lock Box



Ideal Lock Box for complex work team lockout applications.

- ▶ Allows one worker to control lockouts of all other team members
- ▶ After machine or process is locked out, all keys are placed in lock box
- ▶ Group leaders place lock on lock box until job is complete and all group members are cleared from work area
- ▶ Constructed from heavy duty steel

### STANDARD PACKAGE: 1



| PART NO. | DIMENSIONS (W X H X D) | COLOUR |
|----------|------------------------|--------|
| 65672    | 250 x 150 x 100mm      | Yellow |

\*Padlocks not included.

## Extra-Large Group Wall Lock Box

▼ 856839



▼ 870443



Ensure the safety of all workers by keeping energy sources locked out until everyone is finished and centralising the location of your lockout supplies.

- ▶ Extra large size holds up to 50 padlocks inside the lock box and 53 around the box
- ▶ The large size holds up to 30 padlocks inside and up to 24 around the box
- ▶ Constructed from durable polypropylene with a 6mm clear polycarbonate lid and stainless steel backing with hooks
- ▶ Includes self opening struts for ease of use
- ▶ Can be mounted to rail or directly onto walls
- ▶ Comes with clipboard spring on front of lid

### STANDARD PACKAGE: 1



| PART NO. | DESCRIPTION                     | DIMENSIONS (W X H X D) |
|----------|---------------------------------|------------------------|
| 856839   | Extra-Large Group Wall Lock Box | 600x820x110mm          |
| 870443   | Large Group Wall Lock Box       | 440x640x110mm          |

\*Padlocks and Hasp not included.



# Wallmount Group Lock Boxes

▼ 854243



▼ 854244



▼ 854245



Efficient way for a group of workers to lockout equipment that has multiple lockout points.

- ▶ Durable metal wall lock box is constructed from steel, powder coated red with a top slot
- ▶ Keyhole slot makes it easy to add keys to the box after it has been locked out
- ▶ Includes clear window that slides out when locks are moved. Includes key pegs and ID labels to simplify key management
- ▶ Predrilled holes and hardware included for quick mounting

## 7 HOLE BOX (854243)

Features seven key pegs that hold up to five keys each. Accommodates up to seven padlocks (not included).

## 12 HOLE BOX (854244)

Features 15 key pegs that hold up to five keys each. Accommodates up to 12 padlocks (not included).

## 26 HOLE BOX (854245)

Features 15 key pegs that hold up to five keys each. Accommodates up to 26 padlocks (not included).

### STANDARD PACKAGE: 1



| PART NO. | DESCRIPTION | DIMENSIONS (W X H X D) |
|----------|-------------|------------------------|
| 854243   | 7 Hole Box  | 203 x 178 x 57mm       |
| 854244   | 12 Hole Box | 426 x 178 x 57mm       |
| 854245   | 26 Hole Box | 429 x 178 x 57mm       |

\*Padlocks not included.

# Mini Wall Lock Box

▼ 50938



Excellent chemical and heat resistance properties.

- ▶ Patented lock rails hold up to eight padlocks
- ▶ Transparent window lets you view contents from outside
- ▶ Slot in front allows key to be inserted when locked
- ▶ Pre drilled holes in back allows for easy installation
- ▶ Comes with six hooks for hanging keys, locks etc inside

### STANDARD PACKAGE: 1



| PART NO. | DESCRIPTION                  | DIMENSIONS (W X H X D) |
|----------|------------------------------|------------------------|
| 50938    | Minature Wall Lock Box       | 120 x 31 x 140mm       |
| 50939    | Extra Key Hooks - Pack of 12 |                        |

\*Padlocks not included.



# PORTABLE LOCKOUT KITS

Lockout kits are ideal for maintenance crews that work across multiple locations. Brady lockout kits provide a portable solution for commonly used lockout devices for both individual and team requirements. Additional lockout kit components are also available to purchase separately.

## Electrician's Mini Lockout Kit



Ensure each electrician has the right components. Pouch has two small D-shackles and belt loops to attach to tool belts for portability. Made of heavy duty nylon.

### STANDARD PACKAGE: 1

#### KIT CONTAINS

- |   |  |
|---|--|
| 1 x Pouch (65292)                           | 1 x Universal Multi-Pole Lockout (66321) |
| 1 x Red Padlock (850821)                    | 1 x Small Plug Lockout (65674)           |
| 5 x Heavy Duty Lockout Tags (65525)         | 1 x 25mm Lockout Jaws (65375/1)          |
| 1 x Small 'No Hole' Breaker Lockout (65396) | 1 x Single Breaker Lockout (65387)       |
| 1 x Large 'No Hole' Breaker Lockout (65397) |  |



| PART NO. | DESCRIPTION                    |
|----------|--------------------------------|
| 848825   | Electrician's Mini Lockout Kit |

## Electrician's Mini Lockout Pouch



Circuit breaker lockouts are an effective and affordable solution for electrician's carrying out day-to-day work. Brady's lockout kit includes a combination of lockouts for older style breakers and more modern DIN style breakers, reducing the need to carry multiple kits.

### STANDARD PACKAGE: 1

#### KIT CONTAINS

- |   |  |
|---|--|
| 1 x Mini Circuit Breaker POS (90844)      | 1 x Universal Multi-Pole Lockout (66321)   |
| 1 x Mini Circuit Breaker PIS (90847)      | 1 x Dang. Do Not Operate - Poly Tags (842377)  |
| 1 x Mini Circuit Breaker POW (90850)      | 1 x Dang. Out Of Service - Poly Tags (842375)  |
| 1 x Mini Circuit Breaker TBLO (90853)     | 1 x Lockout Jaws 25mm (65375/1)  |
| 1 x No Hole Circuit Breaker Small (65396) | 1 x Lockout Pouch (65292)  |
| 1 x No Hole Circuit Breaker Large (65397) | 1 x Red Brady Safety Plus Lock 38mm with Label (850821) or Red Compact Lock (872880) |



| PART NO. | DESCRIPTION   |
|----------|---|
| 848284   | Electrician's Mini Lockout Pouch with Safety Padlock  |
| 873848   | Electrician's Mini Lockout Pouch with Compact Padlock |





# Personal Valve & Electrical Lockout Kit



Provides everything you need to lockout breakers, plugs and valves of various types and sizes.

## STANDARD PACKAGE: 1

### KIT CONTAINS

- |  |   |
|--|---|
| 1 x All Purpose Cable Lockout (50943)                      | 1 x 480/600V Clamp-On Breaker Lockout with Cleat (65397)  |
| 1 x Adjustable Gate Valve Lockout (64057)                  | 2 x Universal Multi-Pole Breaker Lockouts (66321)         |
| 1 x 13mm-64mm Small Ball Valve Lockout (BS07A)             | 3 x 25mm Group Lockout Hasps (65375)                      |
| 1 x 3-in-1 Plug Lockout (PLO23)                            | 3 x Heavy Duty Lockout Tags (65520) with Nylon Cable Ties |
| 2 x 120/277V Clamp-On Breaker Lockouts with Cleats (65396) | 1 x Medium Lockout Toolbox (105906)                       |



| PART NO. | DESCRIPTION                            |
|----------|--|
| 105955   | Kit with 3 Keyed-Alike Safety Padlocks |

# Portable Padlock Station



Holds up to 10 padlocks, 6 hasps and 10 tags. Semi-transparent hinged cover with locking mechanism protects contents from harsh environments and prevents unauthorised access. Slots in back for wall mounting, attachable carrying handle facilitates easy portability. Space-saving design minimises footprint.

## DIMENSIONS: 336 x 177 x 63.5mm (WxHxD)

### STATION WITH 5 PADLOCKS CONTAINS

- |   |                                      |
|---|--------------------------------------|
| 1 x Portable Padlock Station (105932)                                     | 2 x 25mm Group Lockout Hasps (65375) |
| 5 x Keyed Differently Safety Padlocks (850821) or Steel Padlocks (850827) | 2 x 35mm Group Lockout Hasps (65376) |
| 5 x Heavy Duty Re-Usable Lockout Tags (65520) with Nylon Cable Ties       |                                      |

### STATION WITH 10 PADLOCKS CONTAINS

- |  |                                      |
|--|--------------------------------------|
| 1 x Portable Padlock Station (105932)                                      | 3 x 25mm Group Lockout Hasps (65375) |
| 10 x Keyed Differently Safety Padlocks (850821) or Steel Padlocks (850827) | 3 x 35mm Group Lockout Hasps (65376) |
| 10 x Heavy Duty Re-Usable Lockout Tags (65520) with Nylon Cable Ties       |                                      |



| PART NO. | DESCRIPTION                                   |
|----------|---|
| 105928   | Padlock Station with 5 Brady Safety Padlocks  |
| 105929   | Padlock Station with 5 Brady Steel Padlocks   |
| 105930   | Padlock Station with 10 Brady Safety Padlocks |
| 105931   | Padlock Station with 10 Brady Steel Padlocks  |
| 105932   | Portable Padlock Station (Unfilled)           |



# Personal Electrical Lockout Kit

Provides lockouts for use on most circuit breakers, electrical plugs and disconnect switches.

## STANDARD PACKAGE: 1

### KIT CONTAINS

- |  |   |
|--|---|
| 1 x Mini Cable Lockout (50940)                             | 1 x Oversized Breaker Lockout (65329)                     |
| 1 x 3-in-1 Plug Lockout (PLO23)                            | 3 x 25mm Group Lockout Hasps (65375)                      |
| 2 x 120/277V Clamp-On Breaker Lockouts with Cleats (65396) | 3 x Heavy Duty Lockout Tags (65520) with Nylon Cable Ties |
| 1 x 480/600V Clamp-On Breaker Lockout with Cleat (65397)   | 1 x Medium Lockout Toolbox (105906)                       |
| 2 x Universal Multi-Pole Breaker Lockout (66321)           |   |



| PART NO. | DESCRIPTION                            |
|----------|--|
| 105960   | Personal Electrical Lockout Kit        |
| 105961   | Kit with 3 Keyed Alike Safety Padlocks |
| 105962   | Kit with 3 Keyed Alike Steel Padlocks  |

# Portable Valve and Electrical Lockout Station

Provides a dual lockout solution for Valve and Electrical Lockouts.

- ▶ Constructed from thermoformed polypropylene for maximum durability
- ▶ Semi transparent hinged cover with locking mechanism protects contents from harsh environments and prevents unauthorised access
- ▶ Slots are in back for easy wall mounting
- ▶ Carry handle facilitates easy portability
- ▶ Includes 4 hooks

**DIMENSIONS:** 431 x 431 x 130mm (WxHxD)

### KIT CONTAINS

- |  |   |
|--|---|
| 1 x Portable Lockout Station (105942)                    | 2 x Universal Multi-pole Breaker Lockouts (66321)                         |
| 1 x Adjustable Gate Valve Lockout (850834)               | 2 x 25mm Group Lockout Hasps (65375/1)                                    |
| 1 x All Purpose Cable Lockout (50943)                    | 1 x 35mm Group Lockout Hasp (65376/1)                                     |
| 1 x Ball Valve Lockout (BS07A)                           | 6 x Keyed Differently Safety Padlocks (850821) or Steel Padlocks (850827) |
| 1 x 3-in-1 Plug Lockout (PLO23)                          | 6 x Heavy Duty, Re-Usable Lockout Tags (65520) w/ Nylon Cable Ties        |
| 2 x 120/277V Clamp-On Breaker Lockouts w/ Cleats (65396) |   |
| 1 x 480/600V Clamp-On Breaker Lockout w/ Cleat (65397)   |   |



| PART NO. | DESCRIPTION                                      |
|----------|--|
| 105933   | Valve & Electrical Lockout Station (No Padlocks) |
| 105934   | Station with 6 Safety Padlocks                   |
| 105935   | Station with 6 Steel Padlocks                    |



# LOCKOUT BOARDS

A successful lockout program begins with the right devices stored in the right places and Brady's lockout station boards are the ideal solution to get you started. Prevent equipment loss and damage by simply having the correct equipment ready for maintenance programs. Additional lockout kit components are also available to purchase separately.

## 5-Lock Board

▼ 51181



**DIMENSIONS:** 394 x 292mm

**STANDARD PACKAGE:** 1

### KIT CONTAINS

5 x Padlocks (850821 or 850827)      1 x 35mm Metal Hasp (65376/1)  
1 x 25mm Metal Hasp (65375/1)      12 x Heavy Duty Tags (65520)



| PART NO. | DESCRIPTION  |
|----------|--|
| 51181    | 5 Lock Board (Filled with Brady Safety Padlocks)     |
| 51186    | 5 Lock Board (Filled with Brady 20mm Steel Padlocks) |
| 50989    | 5 Lock Board (Board Only)                            |

## 10-Lock Board

▼ 51187



**DIMENSIONS:** 343 x 343mm

**STANDARD PACKAGE:** 1

### KIT CONTAINS

10 x Padlocks (850821 or 850827)      2 x 25mm Metal Hasp (65375/1)  
2 x 38mm Metal Hasp (65376/1)      12 x Heavy Duty Tags (65520)



| PART NO. | DESCRIPTION   |
|----------|---|
| 51187    | 10 Lock Board (Filled with Brady Safety Padlocks)     |
| 51188    | 10 Lock Board (Filled with Brady 20mm Steel Padlocks) |
| 50990    | 10 Lock Board (Board Only)                            |

## 20-Lock Board

▼ 51189



**DIMENSIONS:** 292mm x 597mm

**STANDARD PACKAGE:** 1

### KIT CONTAINS

20 x Padlocks (850821 or 850827)      2 x 35mm Metal Hasp (65376/1)  
2 x 25mm Metal Hasp (65375/1)      24 x Heavy Duty Tags (65520)



| PART NO. | DESCRIPTION   |
|----------|---|
| 51189    | 20 Lock Board (Filled with Brady Safety Padlocks)     |
| 51194    | 20 Lock Board (Filled with Brady 20mm Steel Padlocks) |
| 50991    | 20 Lock Board (Board Only)                            |

# 36-Lock Board

▼ 51195



**DIMENSIONS:** 597mm x 546mm

**STANDARD PACKAGE:** 1

## KIT CONTAINS

- 36 x Padlocks (850821 or 850827)
- 3 x 35mm Metal Hasp (65376/1)
- 3 x 25mm Metal Hasp (65375/1)
- 36 x Heavy Duty Tags (65520)



| PART NO. | DESCRIPTION   |
|----------|---|
| 51195    | 36 Lock Board (Filled with Brady Safety Padlocks)     |
| 51196    | 36 Lock Board (Filled with Brady 20mm Steel Padlocks) |
| 50992    | 36 Lock Board (Board Only)                            |

# Lockout Wall Cabinets

▼ 839942



▼ 839943



▼ 839944



Constructed of a light gauge steel and painted a highly visible yellow, these Lockout Wall Cabinets will help remind your employees to lockout and ensure that they have the equipment to do so. Available in three convenient sizes, making it easier for you to have the right number of locks and lockouts for each department or area.

## 178MM CABINET KIT (50159) CONTAINS

- 25 x Lockout Tags
- 4 x Keyed Differently
- 3 x Lockout Hasps – (2 Safety Lockouts, 1 Dual Lockout)

## 279MM CABINET KIT (50160) CONTAINS

- 25 x Lockout Tags
- 8 x Keyed Differently
- 4 x Lockout Hasps – (2 Safety Lockouts, 2 Dual Lockouts)

## 406MM CABINET KIT (50161) CONTAINS

- 75 x Lockout Tags
- 20 x Keyed Differently Padlocks (Aluminium padlocks supplied in component kits)
- 9 x Lockout Hasps – (6 Safety Lockouts, 3 Dual Lockouts)



| PART NO. | DESCRIPTION             | DIMENSIONS       |
|----------|-------------------------|------------------|
| 839942   | 178mm Wall Cabinet Only | 76 x 203 x 178mm |
| 839943   | 279mm Wall Cabinet Only | 76 x 203 x 279mm |
| 839944   | 406mm Wall Cabinet Only | 76 x 305 x 406mm |
| 50159    | Component Kit           | 178mm            |
| 50160    | Component Kit           | 279mm            |
| 50161    | Component Kit           | 406mm            |

**NOTE:** Keep lockout supplies stored in one convenient cabinet. Lockout devices and tags sold separately. purchase one of the component kits to suit cabinet size.







# LOCKOUT STATIONS

Wall-mounted Lockout stations ensure proper storage and organisation of lockout devices for easy accessibility. Suitable for electrical and valve applications, especially where large teams need to apply lockout devices. Additional lockout kit components are also available to purchase separately if needed.

## Combination Wall-Mount Lockout Station

▼ 99692



▼ 50995



This station provides everything you need to lockout both electrical and mechanical control points. Includes universal valve lockout and all purpose cable lockout.

- ▶ Constructed of sturdy polystyrene for maximum durability
- ▶ Pre-drilled holes for easy wall mounting
- ▶ Pegboard style holes for hooks drilled into back and sides
- ▶ Includes 8 hooks
- ▶ Built-in lock rail holds 20-25 locks depending on lock size

**DIMENSIONS: 635 x 760 x 134mm (WxHxD)**

### KIT CONTAINS

|   |   |
|---|---|
| 1 x All Purpose Cable Lockout with 2.4m Sheathed Cable (50943)    | 1 x Wall Switch Lockout (65392)                     |
| 1 x Large Univ. Valve Lockout with Blocking Arm (50899 and 65403) | 1 x 110V Plug Lockout (65674)                       |
| 2 x 120V Snap-On Breaker Lockouts (65387)                         | 1 x 3-in-1 Plug Lockout (PLO23)                     |
| 2 x 120/277V Clamp-On Breaker Lockouts with cleats (65396)        | 1 x 6-25mm Ball Valve Lockout (65666)               |
| 2 x 480/600V Clamp-On Breaker Lockouts with cleats (65397)        | 1 x 31-76mm Ball Valve Lockout (65669)              |
| 2 x Universal Multi-Pole Breaker Lockouts (66321)                 | 2 x 25-63mm Gate Valve Lockouts (65560)             |
| 1 x Oversized Breaker Lockout (65329)                             | 1 x 25-165mm Adjustable Gate Valve Lockout (850834) |
|   | 2 x Labelled Lockout Hasps (65960/1)                |

### COMBINATION LOCKOUT STATION



| PART NO. | DESCRIPTION                                 |
|----------|---|
| 99692    | Extra-Large Lockout Station with Components |
| 50993    | Extra-Large Lockout Station (Station Only)  |

### ENCLOSED COMBINATION LOCKOUT STATION



| PART NO. | DESCRIPTION   |
|----------|---|
| 99695    | Extra-Large Enclosed Lockout Station with Components          |
| 99696    | Station with Components and 18 Brady Safety Padlocks, 25 Tags |
| 50995    | Extra-Large Enclosed Lockout Station (Station Only)           |

# Valve Lockout Station

▼ 99698



▼ 50996



- ▶ Constructed of sturdy polystyrene for maximum durability
- ▶ Pre-drilled holes for easy wall mounting
- ▶ Pegboard style holes for hooks drill into back and sides
- ▶ Includes 6 hooks
- ▶ Built-in lock rail holds 15-20 locks depending on lock size



Brady's local kitting facilities allows us to customise your Lockout Kits. To discuss your requirements, contact your Brady distributor.

**Minimum order quantities apply.**

**DIMENSIONS:** 495mm x 673mm 127mm (WxHxD)

## KIT CONTAINS

- |   |   |
|---|---|
| 1 x All Purpose Cable Lockout with 2.4m Sheathed Cable (50943)    | 1 x 25-63mm Gate Valve Lockout (65560)              |
| 1 x Large Univ. Valve Lockout with Blocking Arm (50899 and 65403) | 1 x 25-165mm Adjustable Gate Valve Lockout (850834) |
| 1 x 110V Plug Lockout (65674)                                     | 2 x Labelled Lockout Hasps (65960/1)                |
| 1 x 3-in-1 Plug Lockout (PLO23)                                   |   |
| 1 x 6-25mm Ball Valve Lockout (65666)                             |   |

## VALVE LOCKOUT STATION



| PART NO. | DESCRIPTION   |
|----------|---|
| 99698    | Large Lockout Station with Components                         |
| 99699    | Station with Components and 12 Brady Safety Padlocks, 25 Tags |
| 99697    | Station with Components and 12 Brady Steel Padlocks, 25 Tags  |
| 50994    | Large Lockout Station (Station Only)                          |

## ENCLOSED VALVE LOCKOUT STATION



| PART NO. | DESCRIPTION   |
|----------|---|
| 99703    | Station with Components and 12 Brady Safety Padlocks, 25 Tags |
| 99704    | Station with Components and 12 Brady Steel Padlocks, 25 Tags  |
| 50996    | Large Enclosed Lockout Station (Station Only)                 |





# Electrical Lockout Station

▼ 99706



▼ 50997



A small lockout station provides everything you need for locking out all types of electrical control points. Includes a mini cable.

- ▶ Constructed of sturdy polystyrene for maximum durability
- ▶ Pre-drilled holes for easy wall mounting
- ▶ Pegboard style holes for hooks drill into back and sides
- ▶ Includes 4 hooks
- ▶ Built-in lock rail holds 10-15 locks depending on lock size

**DIMENSIONS:** 304 x 457 x 101mm (WxHxD)



Brady's local kitting facilities allows us to customise your Lockout Kits. To discuss your requirements, contact your Brady distributor.

***Minimum order quantities apply.***

## KIT CONTAINS

- |  |                                       |
|--|---------------------------------------|
| 1 x Mini Cable Lockout (50940)                             | 1 x Oversized Breaker Lockout (65329) |
| 2 x 120V Snap-On Breaker Lockouts (65387)                  | 1 x Wall Switch Lockout (65392)       |
| 2 x 120/277V Clamp-On Breaker Lockouts with cleats (65396) | 1 x 110V Plug Lockout (65674)         |
| 2 x 480/600V Clamp-On Breaker Lockouts with cleats (65397) | 1 x 3-in-1 Plug Lockout (PLO23)       |
| 2 x Universal Multi-Pole Breaker Lockouts (66321)          | 1 x Small fuse blockout (65690)       |
|  | 1 x Large fuse blockout (65691)       |
|  | 2 x Labelled Lockout Hasps (65960/1)  |



| PART NO. | DESCRIPTION  |
|----------|--|
| 99706    | Station with Components & 6 Brady Safety Padlocks, 12 Tags |
| 99707    | Station with Components & 6 Brady Steel Padlocks, 12 Tags  |
| 50997    | Small Lockout Station (Station Only)                       |

# LOCKOUT TAGS



Lockout tags are a critical component of an effective lockout procedure. Brady's range of lockout tags has been designed to comply with every performance standard. Communicate your equipment status message clearly at the energy source to ensure safety during maintenance programs.

## Photo Identification Tags



Make it easy to identify individual workers with photo identification tags.

- ▶ Photographs can be taken with most ID cameras
- ▶ These tags provide long lasting protection and are available in self laminating material
- ▶ Self laminating tags can be personalised by writing on special instructions, hazards or warnings then protect and seal your message with a clear adhesive overlay
- ▶ Constructed of Brady's durable B-851 polyester with a 1mm polyester overlay
- ▶ Tags are supplied with nylon fasteners
- ▶ Photo area is 21 x 21mm
- ▶ Grommet area is 9.5mm diameter

**STANDARD PACKAGE: 10**

**DIMENSIONS: 76mm x 144mm (W x H)**



| PART NO. | DESCRIPTION                     |
|----------|---------------------------------|
| 65501    | Self Laminating Photo I.D. Tags |







# Brady Lockout Tags

All tags have write-on surfaces and come in packages of 25 tags.

## HEAVY DUTY POLYESTER (B-837)

- ▶ Heavy construction prevents accidental removal – withstands up to 36kg of pullout force
- ▶ Constructed from polyester laminate protects graphics, wipes clean, weather resistant and withstands grease and extreme temperatures
- ▶ Brass grommet measures 11mm accepting most standard padlocks

## ECONOMY POLYESTER (B-851)

- ▶ Rigid vinyl surface is easy to write on and stays legible longer
- ▶ Wipes clean easily ready to use again and again
- ▶ Brass grommet measures 9mm accepting most standard padlocks

## CARDSTOCK (B-853)

- ▶ Cost effective and designed for one-time use
- ▶ Cardstock material accepts pen, pencil and marker writing
- ▶ Brass grommet measures 9mm accepting most standard padlocks

## STANDARD PACKAGE: 25



| DESCRIPTION               | MATERIAL | DIMENSIONS (W X H) | GROMMET    |
|---------------------------|----------|--------------------|------------|
| Heavy Duty Polyester Tags | B-837    | 76 x 140mm         | 11mm Brass |
| Economy Polyester Tags    | B-851    | 76 x 144mm         | 9mm Brass  |
| Cardstock                 | B-853    | 76 x 144mm         | 9mm Brass  |

## REVERSE SIDE OPTIONS

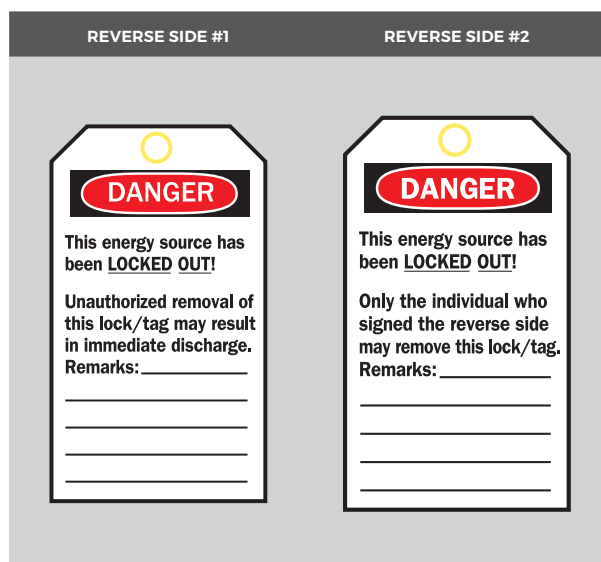

| HEAVY DUTY POLYESTER (B-837) |       |
|------------------------------|-------|
| Rev.Side #1                  | 65502 |
| Rev.Side #2                  | 65535 |
| ECONOMY POLYESTER (B-851)    |       |
| Rev.Side #1                  | 66050 |
| Rev.Side #2                  | 66051 |
| CARDSTOCK (B-853)            |       |
| Rev.Side #1                  | 66068 |
| Rev.Side #2                  | 66069 |



| HEAVY DUTY POLYESTER (B-837) |       |
|------------------------------|-------|
| Rev.Side #1                  | 65506 |
| Rev.Side #2                  | 65534 |
| ECONOMY POLYESTER (B-851)    |       |
| Rev.Side #1                  | -     |
| Rev.Side #2                  | 66060 |
| CARDSTOCK (B-853)            |       |
| Rev.Side #1                  | 66077 |
| Rev.Side #2                  | 66078 |



**DANGER**

**DO NOT OPERATE**

Maintenance Department  
This lock/tag may only be removed by:  
Name \_\_\_\_\_  
Dept. \_\_\_\_\_  
Date \_\_\_\_\_

**DANGER**

**DO NOT OPERATE**

Electricians At Work  
This lock/tag may only be removed by:  
Name \_\_\_\_\_  
Dept. \_\_\_\_\_  
Date \_\_\_\_\_

**DANGER**

**DO NOT START**

This lock/tag may only be removed by:  
Name \_\_\_\_\_  
Dept. \_\_\_\_\_  
Date \_\_\_\_\_

**HEAVY DUTY POLYESTER (B-837)**

Rev.Side #1 65503

Rev.Side #2 65521

**ECONOMY POLYESTER (B-851)**

Rev.Side #1 66053

Rev.Side #2 66054

**CARDSTOCK (B-853)**

Rev.Side #1 66071

Rev.Side #2 66072

**HEAVY DUTY POLYESTER (B-837)**

Rev.Side #1 65504

Rev.Side #2 65522

**ECONOMY POLYESTER (B-851)**

Rev.Side #1 66055

Rev.Side #2 66056

**CARDSTOCK (B-853)**

Rev.Side #1 66073

Rev.Side #2 66074

**HEAVY DUTY POLYESTER (B-837)**

Rev.Side #1 65505

Rev.Side #2 65523

**ECONOMY POLYESTER (B-851)**

Rev.Side #1 66057

Rev.Side #2 -

**CARDSTOCK (B-853)**

Rev.Side #1 66075

Rev.Side #2 66076

**DANGER**

**DO NOT OPERATE**

I certify that the following tasks have been performed to lockout this equipment.

- Identified all potential hazards and energy sources
- Informed operator supervisor about work to be done.
- Prepared equipment for shutdown
- Shutdown/turned off equipment
- Isolated and locked out energy sources
- Released all stored energy
- Tested equipment for zero energy state
- Cleared personnel tools before and after job
- Removed locks and tags

Name \_\_\_\_\_  
Dept. \_\_\_\_\_  
Date \_\_\_\_\_

**DANGER**

**DO NOT OPERATE**

This lock/tag may only be removed by:  
Name \_\_\_\_\_  
Dept. \_\_\_\_\_  
Date \_\_\_\_\_

**DANGER**

**LOCKED OUT**

**DO NOT OPERATE**

This lock/tag may only be removed by:  
Name \_\_\_\_\_  
Dept. \_\_\_\_\_  
Date \_\_\_\_\_

**HEAVY DUTY POLYESTER (B-837)**

Rev.Side #1 65515

Rev.Side #2 65524

**ECONOMY POLYESTER (B-851)**

Rev.Side #1 66061

Rev.Side #2 66062

**CARDSTOCK (B-853)**

Rev.Side #1 66079

Rev.Side #2 -

**HEAVY DUTY POLYESTER (B-837)**

Rev.Side #1 65520

Rev.Side #2 65525

**ECONOMY POLYESTER (B-851)**

Rev.Side #1 66063

Rev.Side #2 66064

**CARDSTOCK (B-853)**

Rev.Side #1 66081

Rev.Side #2 66082

**HEAVY DUTY POLYESTER (B-837)**

Rev.Side #1 65526

Rev.Side #2 65527

**ECONOMY POLYESTER (B-851)**

Rev.Side #1 66066

Rev.Side #2 66067

**CARDSTOCK (B-853)**

Rev.Side #1 66084

Rev.Side #2 66085



# Large Economy Lockout Tags

Choose from cardstock or polypropylene. Tags measure 100 x 150mm in size with a 6mm diameter hole.



| DESCRIPTION   | QTY |
|---------------|-----|
| Cardstock     | 100 |
| Polypropylene | 10  |

## REVERSE SIDE OPTIONS



| REVERSE SIDE 1 |        |
|----------------|--------|
| Cardstock      | 842357 |
| Polypropylene  | 842375 |



| REVERSE SIDE 1 |        |
|----------------|--------|
| Cardstock      | 842358 |
| Polypropylene  | 842376 |



| REVERSE SIDE 1 |        |
|----------------|--------|
| Cardstock      | 842359 |
| Polypropylene  | 842377 |



| REVERSE SIDE 1 |        |
|----------------|--------|
| Cardstock      | 842362 |
| Polypropylene  | 842380 |

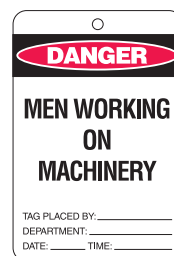

| REVERSE SIDE 1 |        |
|----------------|--------|
| Cardstock      | 842363 |
| Polypropylene  | 842381 |



| REVERSE SIDE 1 |        |
|----------------|--------|
| Cardstock      | 842364 |
| Polypropylene  | 842382 |



| REVERSE SIDE 1 |        |
|----------------|--------|
| Cardstock      | 842374 |
| Polypropylene  | 842392 |



| REVERSE SIDE 1 |        |
|----------------|--------|
| Cardstock      | 842360 |
| Polypropylene  | 842378 |



| REVERSE SIDE 1 |        |
|----------------|--------|
| Cardstock      | 842369 |
| Polypropylene  | 842387 |

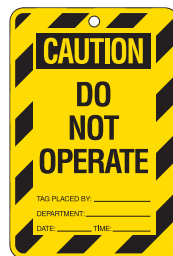

| REVERSE SIDE 2 |        |
|----------------|--------|
| Cardstock      | 842365 |
| Polypropylene  | 842383 |



| REVERSE SIDE 2 |        |
|----------------|--------|
| Cardstock      | 842366 |
| Polypropylene  | 842384 |



| REVERSE SIDE 2 |        |
|----------------|--------|
| Cardstock      | 842367 |
| Polypropylene  | 842385 |



| REVERSE SIDE 2 |        |
|----------------|--------|
| Cardstock      | 842368 |
| Polypropylene  | 842386 |



| REVERSE SIDE 2 |        |
|----------------|--------|
| Cardstock      | 842370 |
| Polypropylene  | 842388 |

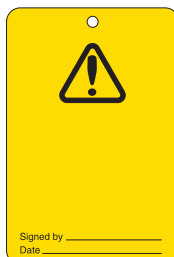

| REVERSE SIDE 2 |        |
|----------------|--------|
| Cardstock      | -      |
| Polypropylene  | 842389 |

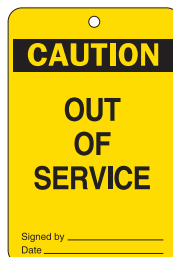

| REVERSE SIDE 2 |        |
|----------------|--------|
| Cardstock      | 842372 |
| Polypropylene  | 842390 |



| REVERSE SIDE 2 |        |
|----------------|--------|
| Cardstock      | 842373 |
| Polypropylene  | 842391 |

# Tie-Out Lockout Tags

Tough 85 x 160mm polypropylene tags resist dirt, grease and moisture. Self locking, no need for string or ties.

**STANDARD PACKAGE: 25**



| DESCRIPTION          | DIMENSIONS (W X L) |
|----------------------|--------------------|
| Tie-Out Lockout Tags | 85 x 100mm         |

## REVERSE SIDES



▼ 847206



▼ 847205



▼ 839909



▼ 839910



▼ 847204



▼ 842552



▼ 842555



▼ 839906



▼ 839904



▼ 842554



▼ 842553



▼ 839905



▼ 842556



▼ 839907







# SCAFFTAG HOLDER & INSERT SYSTEMS

Scafftag is the ultimate solution for tracking the identity, usage, safety, maintenance and inspection status of each and every item of equipment is therefore critical and a key component of your safety program. Most status tagging systems have two components – a holder which attaches permanently to the equipment and replaceable inserts. This creates a simple looped process for latest status and a clear inspection and work data trail.



**1** Empty holder displays: Do not use



**2** Equipment is inspected periodically. Insert completed and placed in holder



**3** If equipment should not be used, remove insert

## Scafftag Mk 1



- ▶ Fits all Standard Scaffolding
- ▶ Secure and easy to use
- ▶ Weatherproof and UV protected
- ▶ Improve Safety procedures in your facility
- ▶ Display equipment status at point of use
- ▶ Durable, high visibility weatherproof holders and inserts
- ▶ Incorporate the holder into your scaffold build for effective use

**HEIGHT:** 305mm

**WIDTH:** 91mm

**MATERIAL:** Polypropylene

**TEMPERATURE:** -20°C to +80°C

**ATTACHMENT METHODS:** Tube

**INSERT DIMENSIONS:** 205 x 85mm (LxW)



| PART NO. | DESCRIPTION                      | QTY   |
|----------|----------------------------------|-------|
| 857184   | Scafftag Mk 1 Complete Kit*      | 1 Kit |
| 857167   | Scafftag Mk 1 Holder             | 10    |
| 857210   | Scafftag Mk 1 Standard Insert    | 50    |
| 865441   | Scafftag Mk 1 Prohibition Insert | 50    |
| 857363   | Scafffile                        | 1     |
| 857227   | Permanent Marking Pen            | 10    |

\* Kit includes: 10 Holders, 20 Standard Inserts and 1 Pen.

# Scafftag Mk 2



- Fits System Scaffolding
- Secure and easy to use
- Weatherproof and UV protected
- Improve Safety procedures in your facility
- Display equipment status at point of use
- Durable, high visibility weatherproof holders and inserts
- Incorporate the holder into your scaffold build for effective use

**HEIGHT:** 285mm

**WIDTH:** 153 mm

**MATERIAL:** Polypropylene

**TEMPERATURE:** -20°C to +80°C

**ATTACHMENT METHODS:** System

**INSERT DIMENSIONS:** 193 x 144mm (LxW)



| PART NO. | DESCRIPTION                   | QTY |
|----------|-------------------------------|-----|
| 857150   | Scafftag Mk 2 Holder          | 10  |
| 857153   | Scafftag Mk 2 Standard Insert | 50  |
| 857227   | Permanent Marking Pen         | 10  |

\* Kit includes: 10 Holders, 10 Standard Inserts and 1 Pen.

# Permit Wallet



- A4 size
- UV resistant
- Transparent – easy to view permits
- Moisture resistant easy access zip closure from top to bottom



| PART NO. | DESCRIPTION      | QTY |
|----------|------------------|-----|
| 857144   | Permit Wallet A4 | 10  |





# Microtag

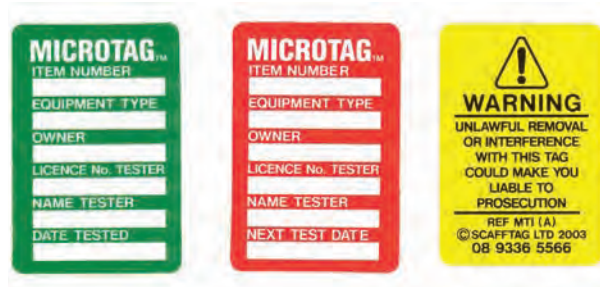

- ▶ Ideal when attachment and display space is limited
- ▶ Commonly used as a date qualified system
- ▶ Microtag also has the facility to render equipment in a 'prohibition status' should it be found to be faulty between inspection dates. This is done by simply removing the insert to expose the message on the holder
- ▶ The compact size allows variable mounting options
- ▶ Colour coded inserts are available to indicate different months or periods

**HEIGHT:** 80mm

**WIDTH:** 38mm

**MATERIAL:** Nylon 6

**TEMPERATURE:** -20°C to +80°C

**INSERT DIMENSIONS:** 47 x 30mm (LxW)

**ATTACHMENT TYPE:** Adhesive, Cable Tie, Screw, Rivet



| PART NO. | DESCRIPTION                               | QTY |
|----------|---|-----|
| 857025   | Microtag Complete Kit*                    | Kit |
| 857067   | Microtag "Date Tested" Insert - Green     | 100 |
| 857068   | Microtag "Date Tested" Insert - Red       | 100 |
| 857069   | Microtag "Date Tested" Insert - White     | 100 |
| 857070   | Microtag "Date Tested" Insert - Yellow    | 100 |
| 857054   | Microtag "Date Tested" Multi Pack**       | 100 |
| 857059   | Microtag "Next Test Date" Insert - Blue   | 100 |
| 857060   | Microtag "Next Test Date" Insert - Orange | 100 |
| 857061   | Microtag "Next Test Date" Insert - White  | 100 |
| 857062   | Microtag "Next Test Date" Insert - Yellow | 100 |
| 857063   | Microtag "Next Test Date" Insert - Green  | 100 |
| 857064   | Microtag "Next Test Date" Insert - Purple | 100 |
| 857065   | Microtag "Next Test Date" Insert - Red    | 100 |
| 857041   | Microtag "Next Test Date" Insert - Black  | 100 |
| 857227   | Permanent Marking Pen                     | 10  |

\* Kit 1 includes: 20 Holders, 40 6" Black Cable Ties and 1 Pen

\*\* Pack includes: 25 each of Blue, Green, Red, Yellow inserts

# Nanotag



- ▶ Provides total flexibility with the option for cable tie or split ring attachment
- ▶ Nanotag is ideal for fall protection equipment such as harnesses
- ▶ Purpose designed for the identification and qualification of equipment with minimal attachment space such as eye bolts, shackles, hoses, cables, breathing apparatus and small power tools
- ▶ Nanotag uses the holder and insert system to ensure the latest equipment status is visible at point of use

**HEIGHT:** 55mm

**WIDTH:** 26mm

**MATERIAL:** Nylon 6

**TEMPERATURE:** -20°C to +80°C

**INSERT DIMENSIONS:** 34 x 18mm (LxW)

**ATTACHMENT TYPE:** Split Ring, Adhesive, Cable Tie, Screw, Rivet



| PART NO. | DESCRIPTION                                    | QTY |
|----------|--|-----|
| 857120   | Nanotag Complete Kit                           | Kit |
| 857107   | Nanotag "Next Inspection Date" Insert - Blue   | 100 |
| 857108   | Nanotag "Next Inspection Date" Insert - Green  | 100 |
| 857110   | Nanotag "Next Inspection Date" Insert - White  | 100 |
| 857111   | Nanotag "Next Inspection Date" Insert - Yellow | 100 |
| 857112   | Nanotag "Next Test Date" Insert - Blue         | 100 |
| 857116   | Nanotag "Next Test Date" Insert - Red          | 100 |
| 857117   | Nanotag "Next Test Date" Insert - White        | 100 |
| 857118   | Nanotag "Next Test Date" Insert - Yellow       | 100 |
| 857227   | Permanent Marking Pen                          | 10  |

\* Kit 1 includes: 20 Holders, 40 6" Black Cable Ties and 1 Pen







# Universal Tag



▼ 857290



▼ 857291

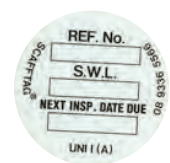

▼ 857288



▼ 857289



▼ 857292



- ▶ An extremely robust permanent holder and insert system to help ensure security in terms of attachment
- ▶ Once the two parts of the holder are locked together it can only be removed with the use of wire cutters or pliers
- ▶ Plastic, stainless steel or nylon covered galvanised wire strops are available in differing lengths (6", 9" and 12") to suit your attachment requirements
- ▶ Universal Tag is designed for the identification and qualification of lifting equipment, industrial plant valves and calibration equipment
- ▶ Inserts are available in a wide range of colours to help visually indicate different months or periods

**DIAMETER: 46mm**

**MATERIAL: Nylon 6**

**TEMPERATURE: -20°C to +80°C**

**INSERT DIMENSIONS: 41mm (Dia.)**

**ATTACHMENT TYPE: Strop**



| PART NO. | DESCRIPTION                                     | QTY |
|----------|---|-----|
| 857251   | Universal Tag 6" Plastic Strop Kit*             | Kit |
| 857253   | Universal Tag 9" Plastic Strop Kit*             | Kit |
| 857252   | Universal Tag 6" Nylon Covered Wire Strop Kit*  | Kit |
| 857310   | Universal Tag 9" Nylon Covered Wire Strop Kit*  | Kit |
| 857309   | Universal Tag 12" Nylon Covered Wire Strop Kit* | Kit |
| 857272   | Universal Tag 6" Stainless Steel Strop Kit*     | Kit |
| 857273   | Universal Tag 9" Stainless Steel Strop Kit*     | Kit |
| 857288   | Universal Tag Safe Working Load Insert - Blue   | 20  |
| 857289   | Universal Tag Safe Working Load Insert - Green  | 20  |
| 857290   | Universal Tag Safe Working Load Insert - Red    | 20  |
| 857291   | Universal Tag Safe Working Load Insert - White  | 20  |
| 857292   | Universal Tag Safe Working Load Insert - Yellow | 20  |
| 857277   | Universal Tag Next Inspection Due - Green       | 20  |
| 857279   | Universal Tag Next Inspection Due - Yellow      | 20  |
| 857278   | Universal Tag Next Inspection Due - Red         | 20  |
| 857276   | Universal Tag Next Inspection Due - Blue        | 20  |
| 857227   | Permanent Marking Pen                           | 10  |

\* Kit includes: 20 Holders, 20 Strops and 1 Pen.



# LOCKOUT SIGNS & LABELS

Communicate lockout messages effectively with Brady's range of signs and labels. Available in various sizes, colours, materials and styles you can easily select the message relevant to your safety and maintenance program. If you cannot find the exact message you are looking for, ask Brady about a customised solution today.

## MATERIAL OPTIONS



| POLY          | MAG            | SAV                 |
|---------------|----------------|---------------------|
| Polypropylene | Magnetic Vinyl | Self Adhesive Vinyl |

## Lockout Tagout Signs



| PART NO. | MATERIAL | SIZE    |
|----------|----------|---------|
| 835753   | POLY     | 300x450 |
| 833902   | MAG      | 125x180 |



| PART NO. | MATERIAL | SIZE    |
|----------|----------|---------|
| 835751   | POLY     | 300x450 |
| 833903   | MAG      | 125x180 |

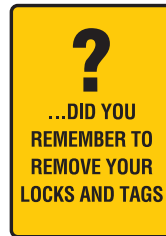

| PART NO. | MATERIAL | SIZE    |
|----------|----------|---------|
| 835743   | POLY     | 450x600 |
| 835744   | POLY     | 300x450 |



| PART NO. | MATERIAL | SIZE    |
|----------|----------|---------|
| 835746   | POLY     | 300x450 |
| 833262   | SAV      | 180x250 |



| PART NO. | MATERIAL | SIZE    |
|----------|----------|---------|
| 841792   | POLY     | 300x450 |
| 841793   | SAV      | 180x250 |



| PART NO. | MATERIAL | SIZE    |
|----------|----------|---------|
| 841796   | POLY     | 300x450 |
| 841797   | SAV      | 180x250 |



| PART NO. | MATERIAL | SIZE    |
|----------|----------|---------|
| 841790   | POLY     | 300x450 |
| 841791   | SAV      | 180x250 |



| PART NO. | MATERIAL | SIZE    |
|----------|----------|---------|
| 841794   | POLY     | 300x450 |
| 841795   | SAV      | 180x250 |



| PART NO. | MATERIAL | SIZE    |
|----------|----------|---------|
| 835742   | POLY     | 300x450 |



| PART NO. | MATERIAL | SIZE    |
|----------|----------|---------|
| 840311   | SAV      | 300x125 |



| PART NO. | MATERIAL | SIZE    |
|----------|----------|---------|
| 841783   | SAV      | 300x125 |



## Lockout Tagout Signs



| PART NO. | MATERIAL | SIZE    |
|----------|----------|---------|
| 841788   | POLY     | 300x450 |
| 841789   | SAV      | 180x250 |



| PART NO. | MATERIAL | SIZE    |
|----------|----------|---------|
| 835747   | POLY     | 300x450 |
| 832781   | MAG      | 125x180 |



| PART NO. | MATERIAL | SIZE    |
|----------|----------|---------|
| 856795   | POLY     | 450x300 |
| 854223   | SAV      | 250x180 |



| PART NO. | MATERIAL | SIZE    |
|----------|----------|---------|
| 856793   | POLY     | 450x300 |
| 856792   | SAV      | 250x180 |



| PART NO. | MATERIAL | SIZE    |
|----------|----------|---------|
| 840308   | SAV      | 300x125 |



| PART NO. | MATERIAL | SIZE    |
|----------|----------|---------|
| 846313   | SAV      | 300x125 |

## Arc Flash & Lockout Labels



| PART NO. | MATERIAL | SIZE    |
|----------|----------|---------|
| 854231   | SAV      | 250x180 |
| 854230   | SAV      | 125x90  |
| 854229   | SAV      | 90x55   |
| 854228   | SAV      | 45x38   |



| PART NO. | MATERIAL | SIZE    |
|----------|----------|---------|
| 856802   | SAV      | 250x180 |
| 856801   | SAV      | 125x90  |
| 856800   | SAV      | 90x55   |
| 856799   | SAV      | 45x38   |



| PART NO. | MATERIAL | SIZE    |
|----------|----------|---------|
| 854223   | SAV      | 250x180 |
| 854222   | SAV      | 125x90  |
| 854221   | SAV      | 90x55   |
| 854220   | SAV      | 45x38   |

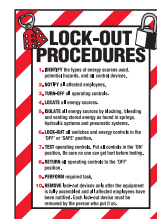

| PART NO. | MATERIAL | SIZE    |
|----------|----------|---------|
| 854232   | SAV      | 180x250 |



| PART NO. | MATERIAL | SIZE    |
|----------|----------|---------|
| 854215   | SAV      | 100x100 |



| PART NO. | MATERIAL | SIZE    |
|----------|----------|---------|
| 854237   | SAV      | 100x100 |



| PART NO. | MATERIAL | SIZE    |
|----------|----------|---------|
| 852656   | SAV      | 180x250 |
| 856803   | SAV      | 90x125  |



| PART NO. | MATERIAL | SIZE    |
|----------|----------|---------|
| 833274   | SAV      | 180x250 |
| 833340   | SAV      | 90x125  |



# Arc Flash & Lockout Labels



| PART NO. | MATERIAL | SIZE    |
|----------|----------|---------|
| 854206   | SAV      | 250x180 |
| 854205   | SAV      | 125x90  |
| 854204   | SAV      | 90x55   |
| 854203   | SAV      | 45x38   |



| PART NO. | MATERIAL | SIZE    |
|----------|----------|---------|
| 854214   | SAV      | 250x180 |
| 854213   | SAV      | 125x90  |
| 854212   | SAV      | 90x55   |
| 854211   | SAV      | 45x38   |



| PART NO. | MATERIAL | SIZE    |
|----------|----------|---------|
| 854210   | SAV      | 250x180 |
| 854209   | SAV      | 125x90  |
| 854208   | SAV      | 90x55   |
| 854207   | SAV      | 45x38   |



| PART NO. | MATERIAL | SIZE    |
|----------|----------|---------|
| 856798   | SAV      | 250x180 |
| 854235   | SAV      | 125x90  |
| 854234   | SAV      | 90x55   |
| 854233   | SAV      | 45x38   |



| PART NO. | MATERIAL | SIZE    |
|----------|----------|---------|
| 854219   | SAV      | 250x180 |
| 854218   | SAV      | 125x90  |
| 854217   | SAV      | 90x55   |
| 854216   | SAV      | 45x38   |



| PART NO. | MATERIAL | SIZE    |
|----------|----------|---------|
| 854227   | SAV      | 250x180 |
| 854226   | SAV      | 125x90  |
| 854225   | SAV      | 90x55   |
| 854224   | SAV      | 45x38   |



| PART NO. | MATERIAL | SIZE    |
|----------|----------|---------|
| 854236   | SAV      | 300x125 |

## Lockout Safety Poster

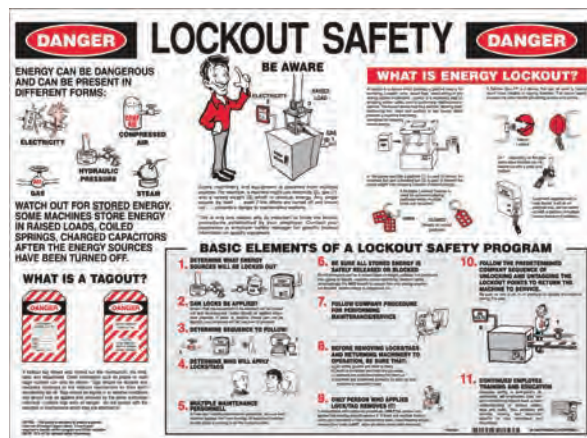

This informative Lockout Safety Poster is a valuable asset to any company, especially when used in conjunction with training and lockout policies. The information will help employees understand lockout and help prevent injuries and save lives by communicating safe lockout procedures.



| PART NO. | DIMENSIONS (WXH)      |
|----------|-----------------------|
| 851355   | 457 x 610mm Laminated |



# Lockout Tagout Checklist

1

## PROGRAM/POLICY

CHECK 

Do you have a written Energy Control / Lockout Tagout Program and procedures in place?

☐

Is your isolation procedure information stored and accessible to employees?

☐

2

## PROCEDURES

Do you have machine-specific Energy Control Procedures?

☐

In cases where machines do not have lockout procedures yet, do you have generic pre-task plans and procedures?

☐

When you upgrade equipment, do you incorporate this into your lockout procedure?

☐

3

## ISOLATION POINTS

Are labels clearly posted to mark energy isolation points?

☐

Do you have your energy sources marked with energy source ID tags?

☐

4

## TRAINING

Do you conduct training for Authorised Employees, Affected Employees and Contracted/Other Employees?

☐

Are your employees trained on your facility-specific lockout devices?

☐

Do you maintain lockout tagout training records?

☐

5

## DEVICES

Do you have a documented equipment list or an asset management system?

☐

Are your padlocks standardised by either colour, shape or size for your site and registered?

☐

Do you have appropriate lockout devices for each type of energy control point in your facility?

☐

Are your lockout devices readily available next to machinery or in a controlled area?

☐

Does your facility include isolation signs and labels?

☐

Do you utilise lockout stations?

☐

6

## SUSTAINABILITY

Do you annually audit your lockout procedures?

☐

Do you consistently track and continuously improve your isolation program?

☐

# Brady Online

**FIND US ONLINE FOR THE LATEST PRODUCT INFORMATION, INTERACTIVE CONTENT, VIDEO DEMOS, INDUSTRY RESOURCES AND SUPPORT TOOLS.**



## **BRADY ONLINE**

[WWW.BRADYID.COM.AU](http://WWW.BRADYID.COM.AU)

- ▶ Find Your Local Distributor
- ▶ Full Detailed Product Offering
- ▶ Workplace Safety Compliance Solutions
- ▶ Industry Specific Application Information
- ▶ Download Product Literature
- ▶ Request a Demo or Sample Pack
- ▶ Firmware & Software Upgrades
- ▶ Customer Service Details
- ▶ Register Brady Products Online

## **BRADYSERVE REDESIGNED FOR BRADY DISTRIBUTORS**

[WWW.BRADYSERVE.COM.AU](http://WWW.BRADYSERVE.COM.AU)

- ▶ Order Online With Up To Date Distributor Pricing
- ▶ Track Your Order Live
- ▶ Create Web Quotes
- ▶ Design & Order Custom Products
- ▶ Send Your Custom Product Design To Users
- ▶ View Order History
- ▶ View Invoices

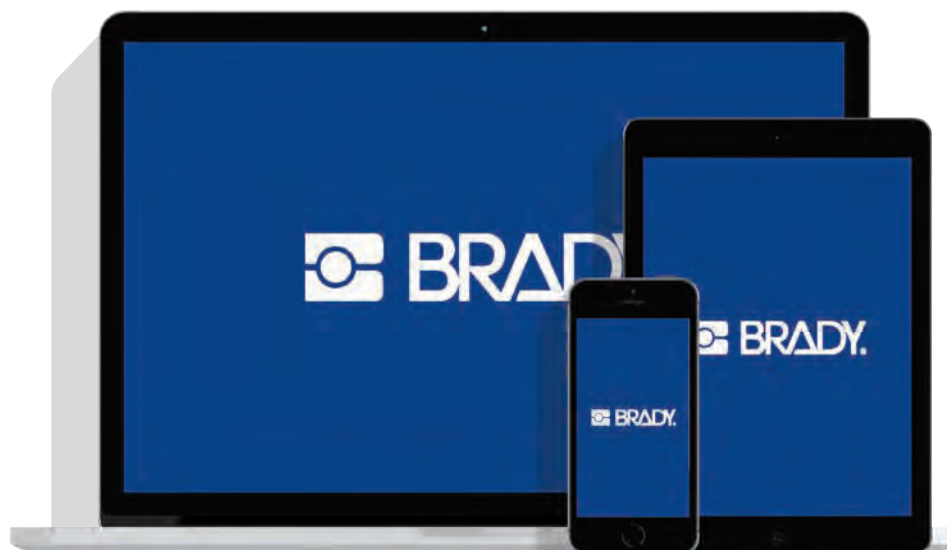

## **WARRANTY**

Brady products are sold with the understanding that the buyers will test them in actual use and determine for themselves their adaptability to their intended uses. Brady warrants to the buyers that its products are free from defects in material and workmanship, but limits its obligation under this warranty to replacement of the product shown to Brady's satisfaction to have been defective at the time Brady sold it. This warranty does not extend to any persons obtaining the product from the buyers. This warranty is in lieu of any other warranty, express or implied, including, but not limited to, any implied warranty of merchantability or fitness for a particular purpose, and of any other obligations or liability on Brady's part.

Under no circumstances will Brady be liable for any loss, damage, expense, or consequential damages of any kind arising in connection with the use, or inability to use, Brady's products.



“ We do things others don't, in ways they can't. This is the Brady way. ”

- BILL BRADY - FOUNDER OF BRADY (1914)



FIRST  
AID



SAFETY  
SIGNS



PRINTERS +  
LABELS



LOCKOUT  
TAGOUT

---

**ELLISCO**  
Your Partner for Global Technology

### Contact Ellisco:

AUCKLAND  
PO Box 87022  
Meadowbank 1742  
Phone: 09 570 5267  
105 Morrin Road, St Johns

WHANGAREI  
Mobile: +64 21 929053

WELLINGTON  
Mobile: 021 531 514  
Email: [info@ellis.co.nz](mailto:info@ellis.co.nz)

NEW PLYMOUTH  
Mobile: 027 940 0781  
Email: [info@ellis.co.nz](mailto:info@ellis.co.nz)

CHRISTCHURCH  
5 Vulcan Place Middleton  
Phone: 03 366 8608  
Fax: 03 366 8609  
Mobile: 021 353 531

**WEBSITE:** [ellis.co.nz](http://ellis.co.nz)